

KEY PLAN: NOT TO SCALE

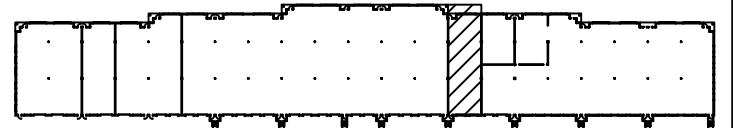

SCALE: 1/8"=1'-0"
 DRAWN: MJK
 DATE: 2/10/11
 CADFILE:2520LORD

REVISIONS:

2520 LORD BALTIMORE DR.
 SUITE 'H'
 WINDSOR CORPORATE CENTER
 BALTIMORE, MD 21244



ST. JOHN PROPERTIES, INC.
 2560 LORD BALTIMORE DR.
 BALTIMORE, MD 21244
 OFFICE: 410-788-0100
 FAX: 410-788-0851

FLOOR PLAN
 TOTAL: 2,760 SQ. FT.
 OFFICE: 2,360 SQ. FT.
 WHSE: 400 SQ. FT.

DRAWING NO.

1 OF 1