

KEY PLAN
NOT TO SCALE

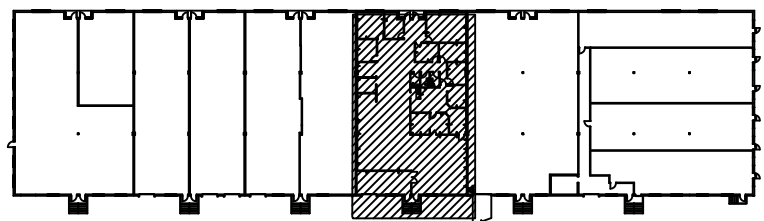

SCALE: NOT TO SCALE
DRAWN: TSB
DATE: 3/13/03
CADFILE: 10540ym
REVISIONS: 6/17/09

10540 YORK ROAD
SUITE 'F-G'
YORKRIDGE CENTER NORTH
COCKEYSVILLE, MD 21030



ST. JOHN PROPERTIES, INC.
2560 LORD BALTIMORE DR.
BALTIMORE, MD 21244
OFFICE: 410-788-0100
FAX: 410-788-0851

FLOOR PLAN
TOTAL: 6,000 SQ. FT.
OFFICE: 5,409 SQ. FT.
WHSE: 591 SQ. FT.

DRAWING NO.

1 OF 1