

KEY PLAN
NOT TO SCALE

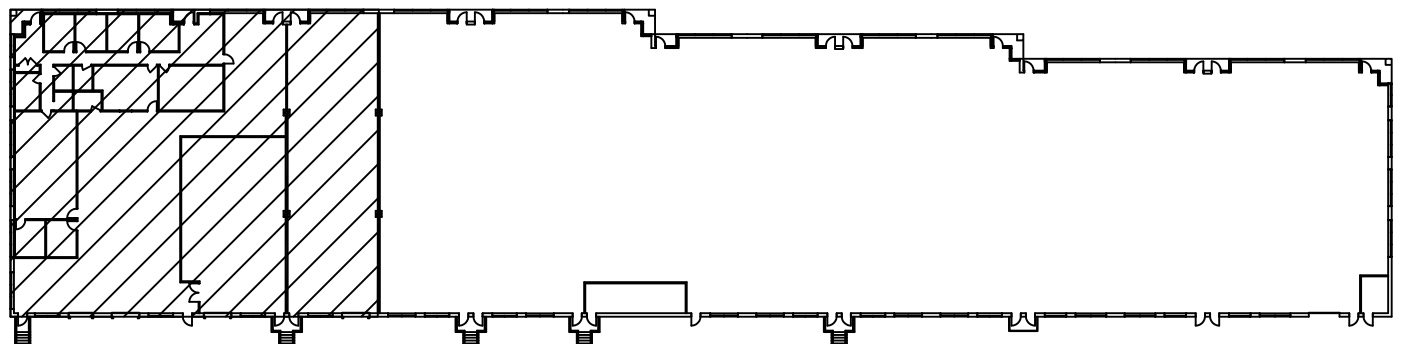

SCALE: 3/32"=1'-0"
DRAWN: MJK
DATE: 1/21/09
CADFILE: 517
PROGRESS.H
REVISIONS:

517 PROGRESS DRIVE
SUITES 'M-Q'
BWI TECHNOLOGY PARK
LINTHICUM, MD 21090



ST. JOHN PROPERTIES, INC.
2560 LORD BALTIMORE DR.
BALTIMORE, MD 21244
OFFICE: 410-788-0100
FAX: 410-788-0851

FLOOR PLAN
TOTAL: 12,000 SQ. FT.
OFFICE: 3,110 SQ. FT.
WHSE: 8,890 SQ. FT.

DRAWING NO.
1 OF 1