

KEY PLAN
NOT TO SCALE

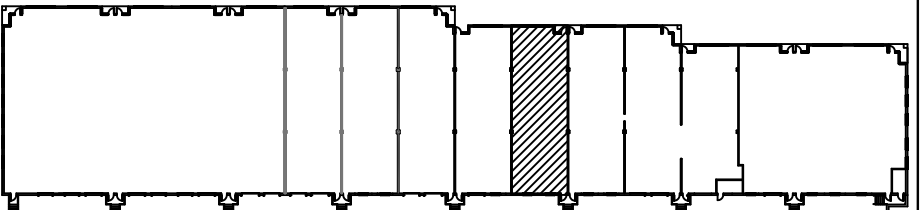

SCALE: 1/8"=1'-0"
DRAWN: MJK
DATE: 9/7/11
CADFILE: 1131BEN
REVISIONS:

1131 BENFIELD BLVD.
SUITE 'G'
I-97 BUSINESS PARK
MILLERSVILLE, MD 21108



ST. JOHN PROPERTIES, INC.
2560 LORD BALTIMORE DR.
BALTIMORE, MD 21244
OFFICE: 410-788-0100
FAX: 410-788-0851

FLOOR PLAN
TOTAL: 2,700 SQ. FT.
OFFICE; 2,700 SQ. FT.

DRAWING NO.

1 OF 1