

TOTAL: 4,500 SQFT.

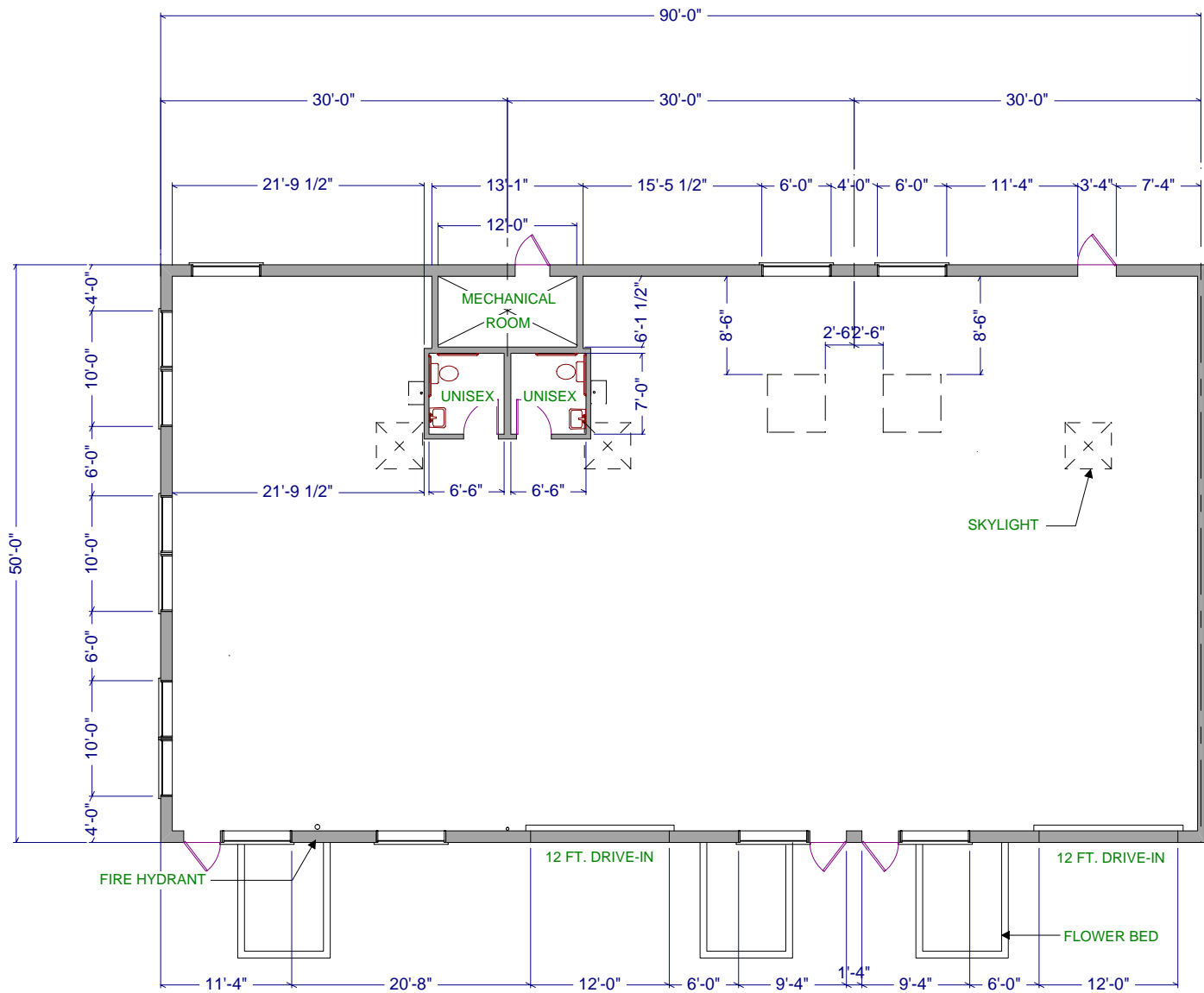

DESIGNED BY:	FAITH HILE
DRAWN BY:	FAITH HILE
CHECKED BY:	
APPROVED BY:	

ST. JOHN PROPERTIES, INC.
 1020 JAMES DR., SUITE G
 HARTLAND, WI 53029

FLOOR PLAN / TENANT BUILDOUT FOR:
MEQUON RESEARCH CENTER II
 10650 N. BAEHR ROAD 60W, SUITE A - F
 MEQUON, WI 53092

PROJECT NO.	DATE
	01-13-09
DRAWING NO.	
MEQII10650A-C	