

TOTAL SF AVAILABLE:
 2,542 SF

KEY PLAN
 NOT TO SCALE

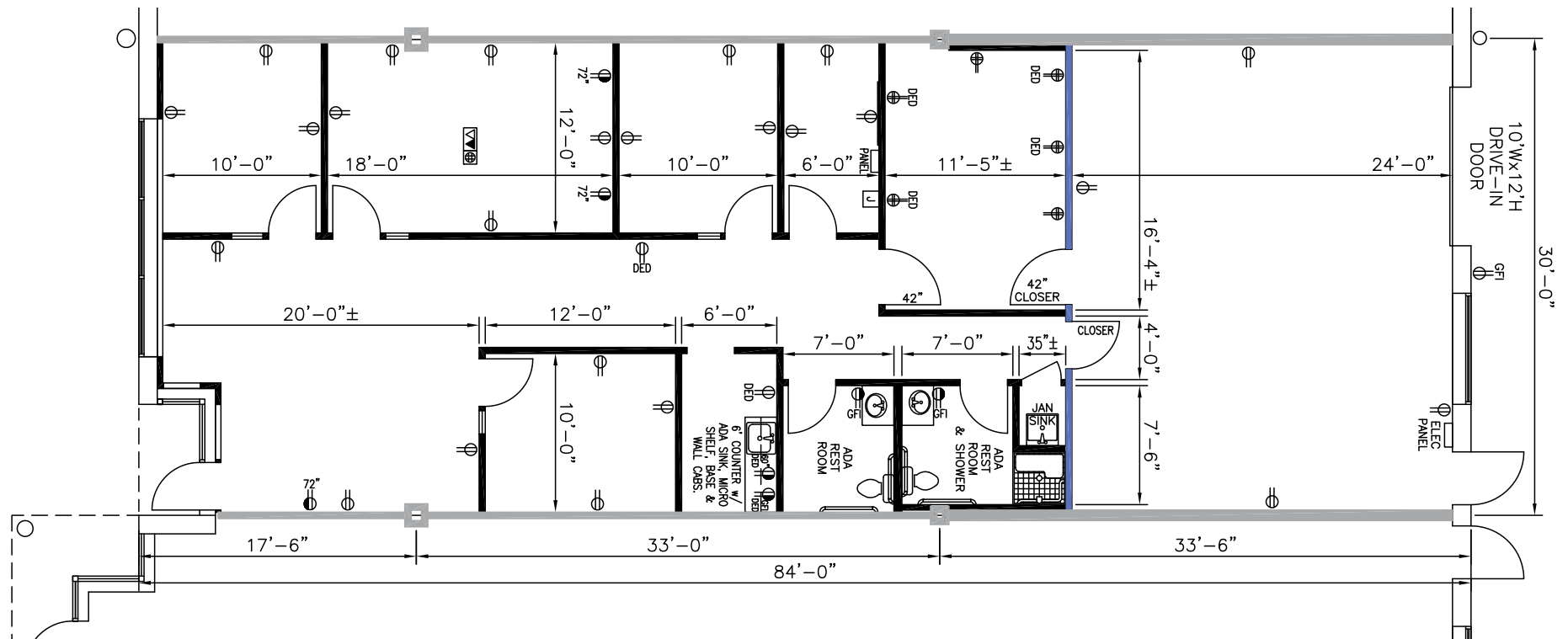

NOTE: THIS SPACE PLAN IS SUBJECT TO EXISTING FIELD CONDITIONS. THIS DRAWING IS PROPRIETARY AND THE EXCLUSIVE PROPERTY OF ST. JOHN PROPERTIES, INC. ANY DUPLICATIONS, DISTRIBUTION, OR OTHER UNAUTHORIZED USE IS STRICTLY PROHIBITED.

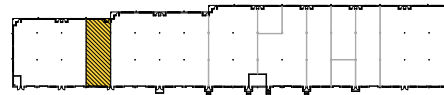

St. John Properties' flex / R&D buildings offer first class, highly efficient work environments in an attractive business park setting.

Flex/R&D buildings provide drive-in or dock height access for integration, production or R&D work.

We are leasing in a wide range of configurations, from small office/warehouse/integration space to entire buildings improved for 100% high-tech office space.

FLEX / R&D SPACE

SINGLE-STORY FLEX / R&D BUILDINGS

6145 Guardian Gateway	54,120 SF	FUTURE
6155 Guardian Gateway	39,120 SF	FUTURE
6165 Guardian Gateway	51,120 SF	LEED GOLD
6175 Guardian Gateway	54,120 SF	LEED GOLD
6240 Guardian Gateway	59,977 SF	

FLEX / R&D SPECIFICATIONS

LEED <i>(on select buildings)</i>	Core & Shell
Suite Sizes	2,520 up to 3,000 SF
Ceiling Height	16 ft. clear minimum
Offices	Built to suit
Parking	4 spaces per 1,000 SF
Heat	Gas
Roof	EPDM rubber or TPO
Exterior Walls	ATFP
Loading	Dock or drive-in

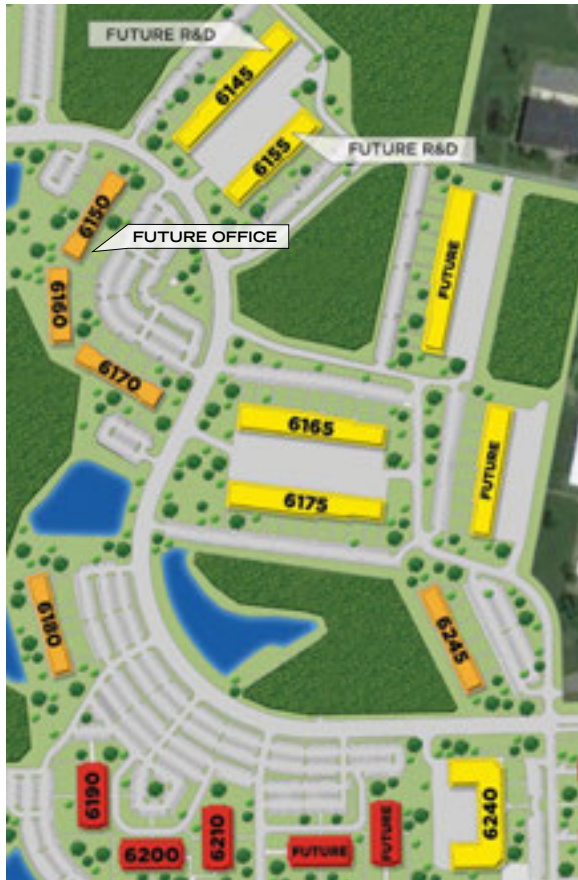



2560 Lord Baltimore Drive
 Baltimore, MD 21244
 410.788.0100 | SJPI.COM
 CO | MD | NV | PA | LA | UT | VA | WI

Follow us on social media @stjohnprop  



For additional leasing information or to schedule a tour, contact:

Matt Lenihan *AVP Leasing*
 410.369.1202 | mlenihan@sjpi.com

Richard Williamson
SVP Leasing & Marketing
 410.369.1222 | rwilliamson@sjpi.com

This information contained in this publication has been obtained from sources believed to be reliable. St. John Properties makes no guarantee, warranty or representation about this information. Any projections, opinions, assumptions or estimates used here are for example only and do not represent the current or future performance of the property. Interested parties should conduct an independent investigation to determine whether the property suits their needs. REV 07/17