

**TOTAL SF AVAILABLE:**  
 5,000 - 21,893 SF

NOTE: THIS SPACE PLAN IS SUBJECT TO EXISTING FIELD CONDITIONS. THIS DRAWING IS PROPRIETARY AND THE EXCLUSIVE PROPERTY OF ST. JOHN PROPERTIES, INC. ANY DUPLICATIONS, DISTRIBUTION, OR OTHER UNAUTHORIZED USE IS STRICTLY PROHIBITED.

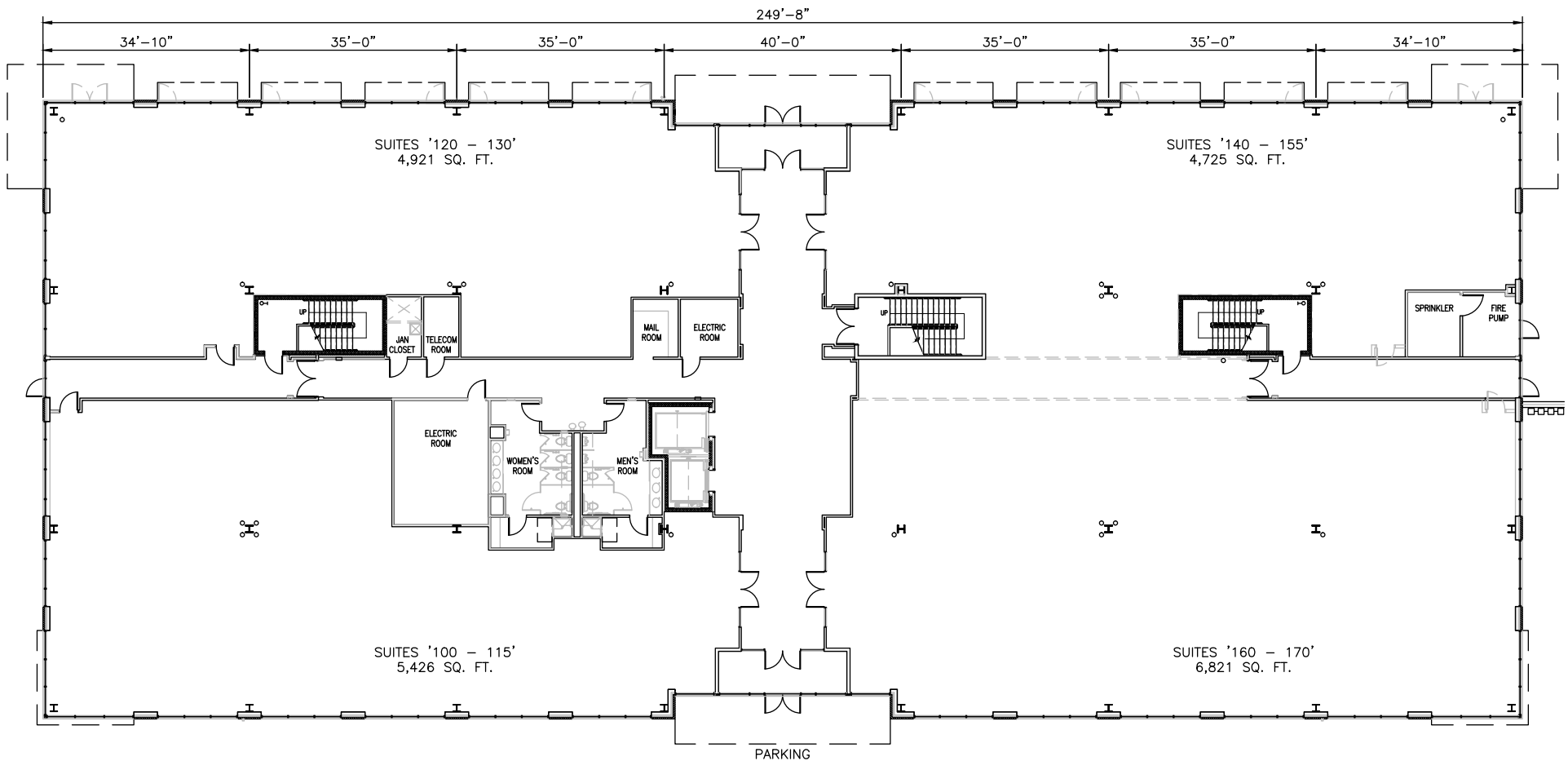

# GREENLEIGH AT CROSSROADS | MULTI-STORY OFFICE



6201 Greenleigh Avenue



## MULTI-STORY OFFICE SPACE

### MULTI-STORY OFFICE BUILDINGS

6201 Greenleigh Avenue	76,980 SF	LEED GOLD DESIGNED
6210 Greenleigh Avenue	100,000 SF	FUTURE
6211 Greenleigh Avenue	100,000 SF	FUTURE

### MULTI-STORY OFFICE SPECIFICATIONS

LEED	Core & Shell
Suite Sizes	5,000 - 100,000 SF
Office	Built to suit
Ceiling Height	10 ft. clear minimum
Parking	4.5 spaces per 1,000 SF
HVAC	Gas, VAV with zone control
Zoning	ML-IM-M43



Multi-story class 'A' office lobby

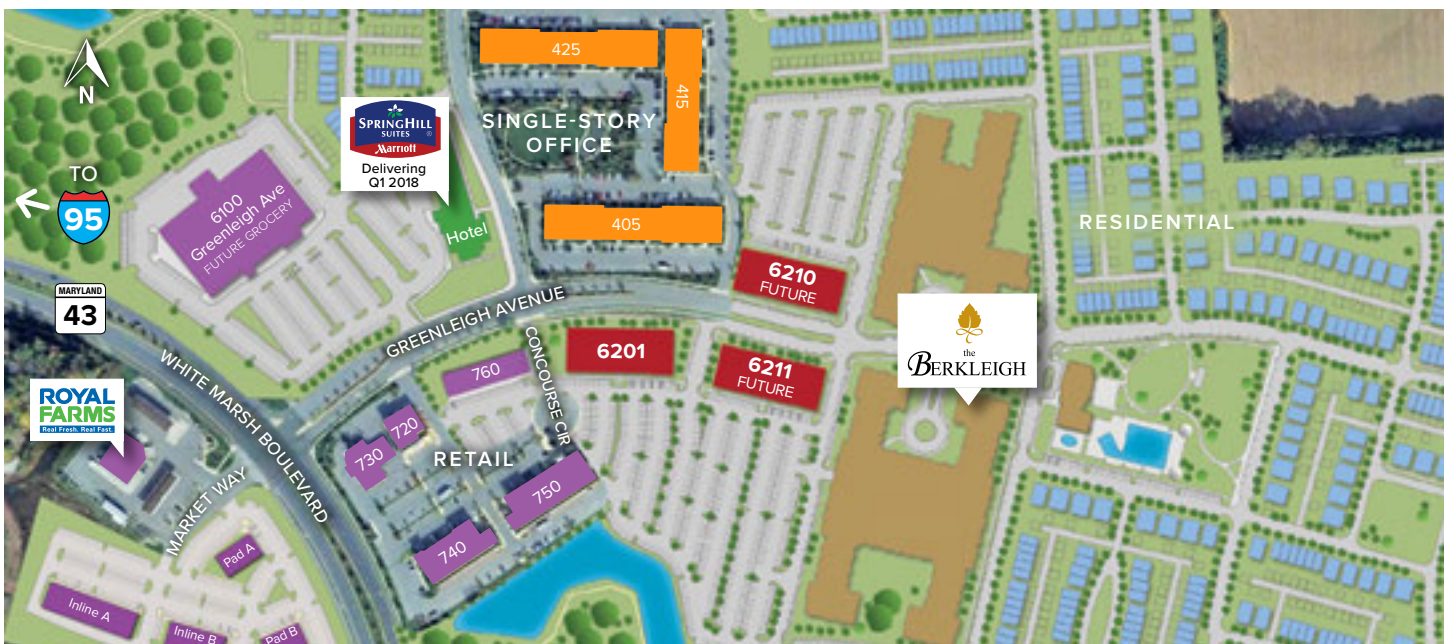



**Distances to:**

- Aberdeen, MD ..... 18 miles
- AMTRAK / MARC Station ..... 1 mile
- BWI Airport ..... 20 miles
- Baltimore (Downtown) ..... 11 miles
- I-695 (Baltimore Beltway) ..... 4 miles
- I-95 ..... 2 miles
- Martin State Airport ..... 1 mile
- Towson, MD ..... 10 miles



2560 Lord Baltimore Drive  
 Baltimore, MD 21244  
 410.788.0100 | SJPI.COM  
 CO | MD | NV | PA | LA | UT | VA | WI



Follow us on social media



**About St. John Properties**

St. John Properties, Inc. is a full-service real estate company headquartered in Baltimore, Maryland. The company owns, manages and has developed more than 18 million square feet of commercial real estate, including flex/R&D, warehouse, office and retail space.

**For additional leasing information or to schedule a tour, contact:**

**OFFICE / FLEX SPACE**

**Matt Lenihan** *Assistant VP, Leasing*  
 410.369.1202 | mlenihan@sjpi.com

**Richard Williamson**  
*SVP Leasing & Marketing*  
 410.369.1222 | rwilliamson@sjpi.com

**RETAIL SPACE**

**Bill Holzman** *VP, Retail Leasing*  
 410.369.1240 | bholzman@sjpi.com

**Brooke Harlander** *Leasing Agent*  
 410.369.1232 | bharlander@sjpi.com

This information contained in this publication has been obtained from sources believed to be reliable. St. John Properties makes no guarantee, warranty or representation about this information. Any projections, opinions, assumptions or estimates used here are for example only and do not represent the current or future performance of the property. Interested parties should conduct an independent investigation to determine whether the property suits their needs. REV 05/17