

**Annapolis Corporate Park**  
183 Harry S. Truman Parkway | Annapolis, MD 21401  
Suites 100-114

**Total SF Available:**  
20,623 SF

**KEY PLAN**  
NOT TO SCALE

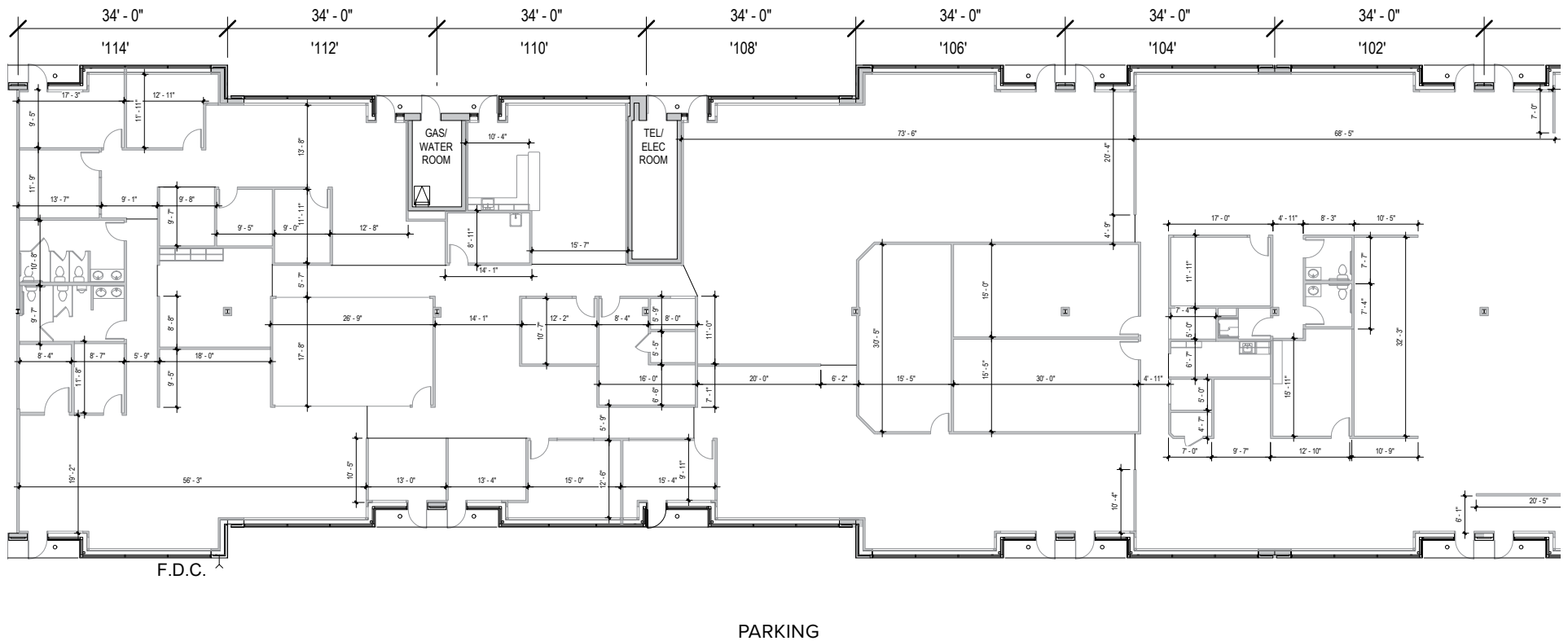
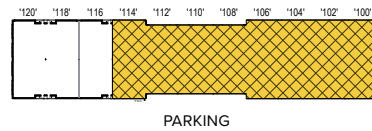

## About Annapolis Corporate Park

Annapolis Corporate Park is located directly off Harry S Truman Parkway near the intersection of Riva Road, immediately south of MD Route 50.

The park is immediately adjacent to Anne Arundel County government offices, within a short walk of numerous amenities, including Subway, Squisito Pizza & Pasta, Corner Café, CVS, BB&T Bank, and more.

Annapolis Corporate Park is just five miles from downtown Annapolis, with quick connections to Baltimore, Columbia, and DC markets, as well as BWI Airport.

*For more information on  
Annapolis Corporate Park, visit:  
[sjpi.com/annapoliscorporate](http://sjpi.com/annapoliscorporate)*



## Multi-Story Class 'A' Office

### Multi-Story Class 'A' Office Buildings

187 Harry S Truman Pkwy 128,317 SF

181 Harry S Truman Pkwy 63,668 SF

### Multi-Story Office Specifications

LEED	Gold   Core & shell
Suite Sizes	2,010 up to 128,317 SF
Ceiling Height	10 ft. clear minimum
Offices	Built to suit
Elevator	Yes
Parking	4.5 spaces per 1,000 SF
HVAC	Gas, VAV + zone control
Zoning	C-2



## Single-Story Office

### Single-Story Office Buildings

183 Harry S Truman Pkwy 28,900 SF

185 Harry S Truman Pkwy 31,280 SF

### Single-Story Office Specifications

LEED	Gold   Core & shell
Suite Sizes	2,240 up to 31,280 SF
Ceiling Height	10 ft. clear minimum
Offices	Built to suit
Parking	5 spaces per 1,000 SF
Heat	Gas
Roof	TPO
Exterior Walls	Brick on block
Zoning	C-2





#### Distances to:

Annapolis, MD (Downtown)	5 miles
Annapolis Towne Centre	1.3 miles
Anne Arundel Medical Center	2.3 miles
Baltimore, MD (Downtown)	27 miles
BWI Airport	22 miles
Interstate 95	23 miles
Interstate 97	2.5 miles
Interstate 495 (Capital Beltway)	18 miles
Interstate 695 (Baltimore Beltway)	20 miles
Washington, D.C. (Downtown)	31 miles
Westfield Annapolis Mall	1.8 miles



2560 Lord Baltimore Drive  
Baltimore, MD 21244

410.788.0100 | [SJPI.COM](http://SJPI.COM)

MD | LA | CO | NV | PA | UT | VA | WI

Connect with us @[stjohnprop](https://twitter.com/stjohnprop)



#### About St. John Properties

St. John Properties, Inc. is a full-service real estate company headquartered in Baltimore, Maryland. The company owns, manages and has developed more than 20 million square feet of commercial real estate, including office, flex/R&D, warehouse, retail and residential space.

#### For additional leasing information or to schedule a tour, contact:

**Stephanie Caronna**  
Leasing Representative  
410.369.1235 | [scaronna@sjpi.com](mailto:scaronna@sjpi.com)

**Sean Doordan**  
Senior VP, Leasing & Acquisitions  
410.369.1211 | [sdoordan@sjpi.com](mailto:sdoordan@sjpi.com)



This information contained in this publication has been obtained from sources believed to be reliable. St. John Properties makes no guarantee, warranty or representation about this information. Any projections, opinions, assumptions or estimates used here are for example only and do not represent the current or future performance of the property. Interested parties should conduct an independent investigation to determine whether the property suits their needs. REV 05/20