

**Total SF Available:**  
3,000 SF

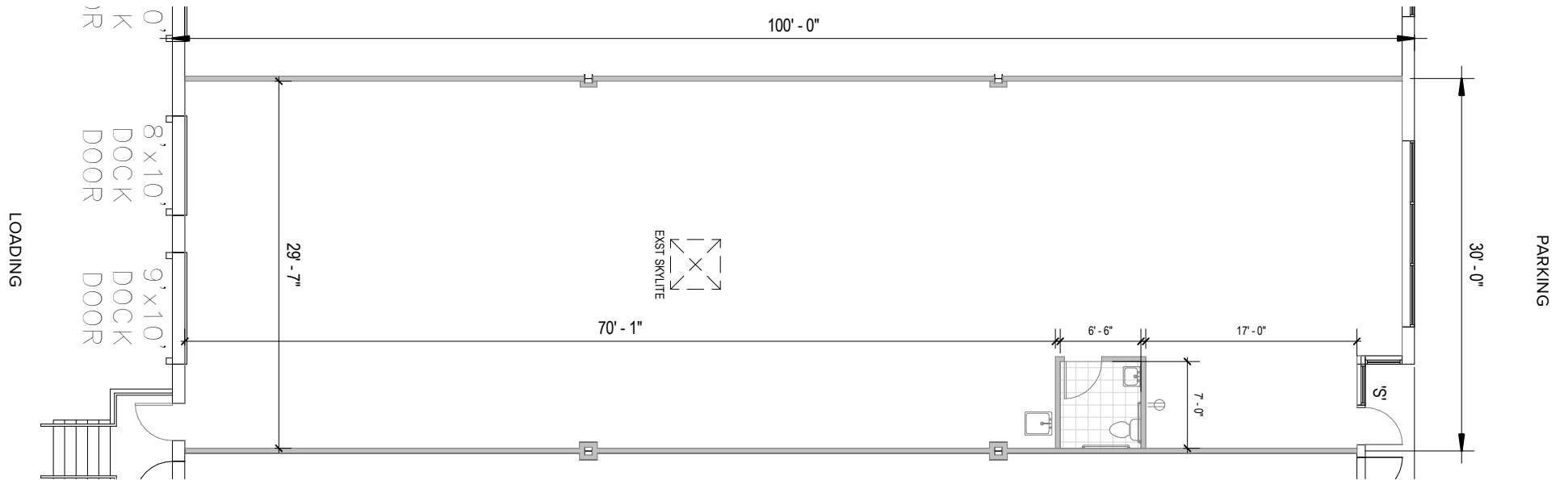
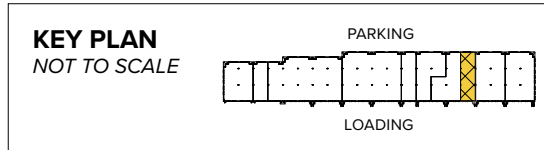

## About Aberdeen Technology Park

Aberdeen Technology Park is an 11-acre business community located near MD Route 22, just off Interstate 95 in Aberdeen, Maryland in Harford County.

The unified architecture of St. John Properties' two buildings, containing more than 97,700 square feet of flex/R&D space, provides Aberdeen Technology Park a campus-like business environment. Tenant sizes from 2,400 square feet to 59,340 square feet of space offer businesses straight-forward, economical and high-utility space in a covenant-protected, well maintained atmosphere. Thirty-foot wide spaces combined with 16-foot high ceiling heights offer maximum flexibility. Free, generous parking is available adjacent to the building.

*For more information on  
Aberdeen Technology Park, visit:  
[sjpi.com/aberdeentech](http://sjpi.com/aberdeentech)*



## Flex/R&D Space

### Flex/R&D Buildings

1200 Technology Drive	59,340 SF
-----------------------	-----------

1202 Technology Drive	38,400 SF
-----------------------	-----------

### Flex/R&D Specifications

Suite Sizes	2,400 up to 59,340 SF
-------------	-----------------------

Ceiling Height	16 ft. clear minimum
----------------	----------------------

Offices	Built to suit
---------	---------------

Parking	4 spaces per 1,000 SF
---------	-----------------------

Heat	Gas
------	-----

Roof	EPDM rubber
------	-------------

Exterior Walls	Brick on block
----------------	----------------

Loading	Dock or drive-in
---------	------------------

Zoning	ORI
--------	-----



**Aberdeen  
Technology  
Park**

ABERDEEN

**THE GATE  
AT APG**

ABERDEEN  
PROVING GROUND

**Distances to:**

- Aberdeen Proving Ground ..... 5 miles
- Baltimore, MD ..... 30 miles
- Bel Air, MD ..... 9 miles
- BWI Airport ..... 38 miles
- Interstate 95 ..... 1 mile
- Interstate 695 ..... 21 miles
- Philadelphia, PA ..... 65 miles
- Port of Baltimore ..... 28 miles
- Washington, D.C. .... 68 miles
- Wilmington, DE ..... 40 miles

**About St. John Properties**

St. John Properties, Inc. is a full-service real estate company headquartered in Baltimore, Maryland. The company owns, manages and has developed more than 20 million square feet of commercial real estate, including office, flex/R&D, warehouse, retail and residential space.



2560 Lord Baltimore Drive  
Baltimore, MD 21244

**410.788.0100 | SJPI.COM**  
MD | CO | LA | NV | PA | UT | VA | WI

**For additional leasing information  
or to schedule a tour, contact:**

**Matt Lenihan**  
*Vice President, Leasing*  
410.369.1202 | mlenihan@sjpi.com

**Sean Doordan**  
*Senior VP, Leasing & Acquisitions*  
410.369.1211 | sdoordan@sjpi.com



Connect with us @stjohnprop    

This information contained in this publication has been obtained from sources believed to be reliable. St. John Properties makes no guarantee, warranty or representation about this information. Any projections, opinions, assumptions or estimates used here are for example only and do not represent the current or future performance of the property. Interested parties should conduct an independent investigation to determine whether the property suits their needs. REV 07/20