

TOTAL SF AVAILABLE:
 18,000 SF

KEY PLAN
 NOT TO SCALE

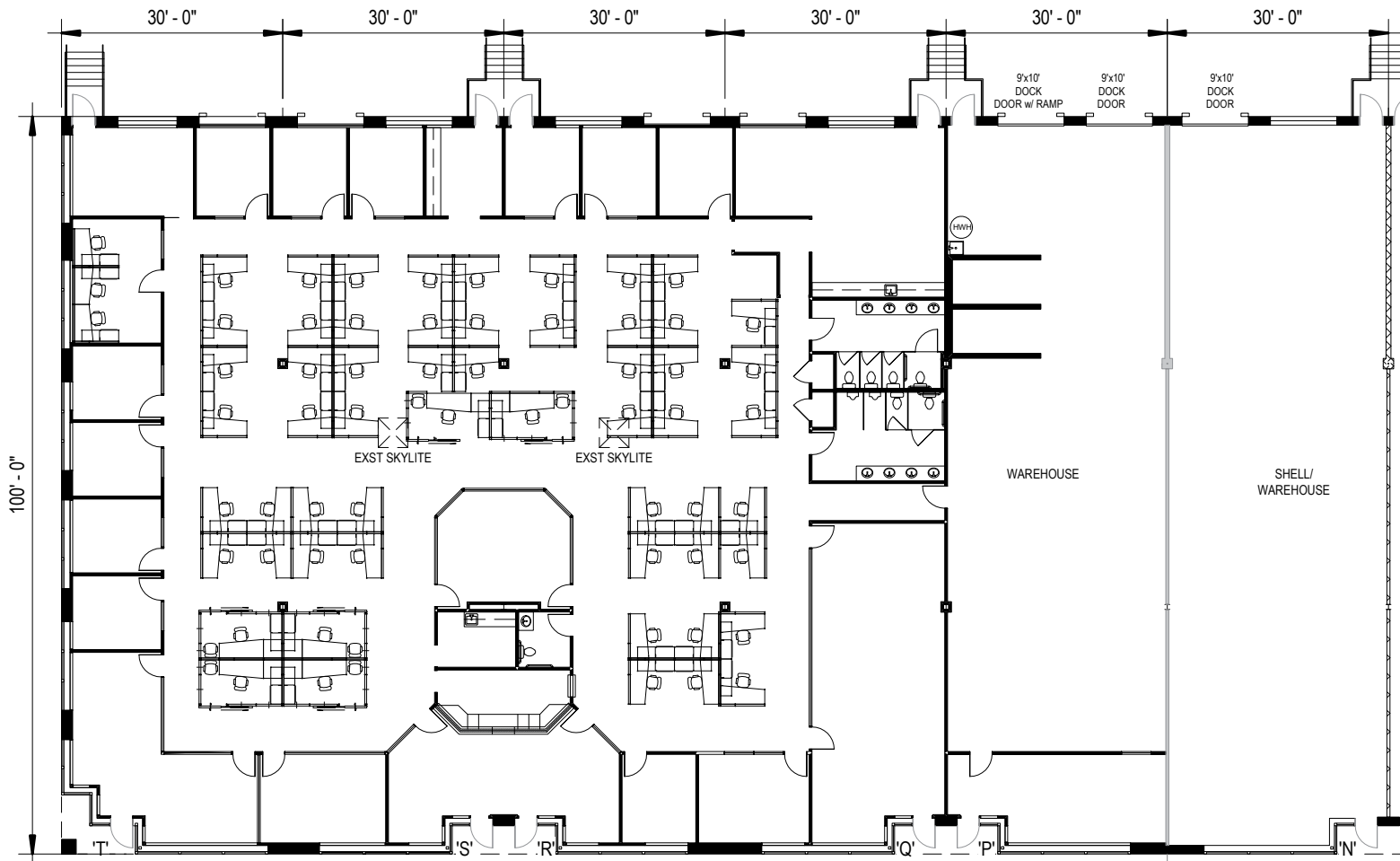

NOTE: THIS SPACE PLAN IS SUBJECT TO EXISTING FIELD CONDITIONS. THIS DRAWING IS PROPRIETARY AND THE EXCLUSIVE PROPERTY OF ST. JOHN PROPERTIES, INC. ANY DUPLICATIONS, DISTRIBUTION, OR OTHER UNAUTHORIZED USE IS STRICTLY PROHIBITED.







Distances to:

Annapolis (Downtown)	22 miles
Arundel Mills Mall	4 miles
Baltimore (Downtown)	8 miles
BWI Airport	2 miles
Columbia	12 miles
I-495 (Capital Beltway)	19 miles
I-695 (Baltimore Beltway)	3 miles
MD 100	4 miles
MD 295	1 miles

About St. John Properties

St. John Properties, Inc. is a full-service real estate company headquartered in Baltimore, Maryland. The company owns, manages and has developed more than 18.5 million square feet of commercial real estate, including ex/R&D, warehouse, office and retail space.



2560 Lord Baltimore Drive
 Baltimore, MD 21244
 410.788.0100 | SJPI.COM
 CO | MD | NV | PA | LA | UT | VA | WI

For additional leasing information
 or to schedule a tour, contact:

Bill Jautze *Leasing Agent*
 410.369.1213 | bjautze@sjpi.com

Richard Williamson
SVP Leasing & Marketing
 410.369.1222 | rwilliamson@sjpi.com

Follow us @stjohnprop   



This information contained in this publication has been obtained from sources believed to be reliable. St. John Properties makes no guarantee, warranty or representation about this information. Any projections, opinions, assumptions or estimates used here are for example only and do not represent the current or future performance of the property. Interested parties should conduct an independent investigation to determine whether the property suits their needs. REV 02/18