

TOTAL SF AVAILABLE:
1,000 SF

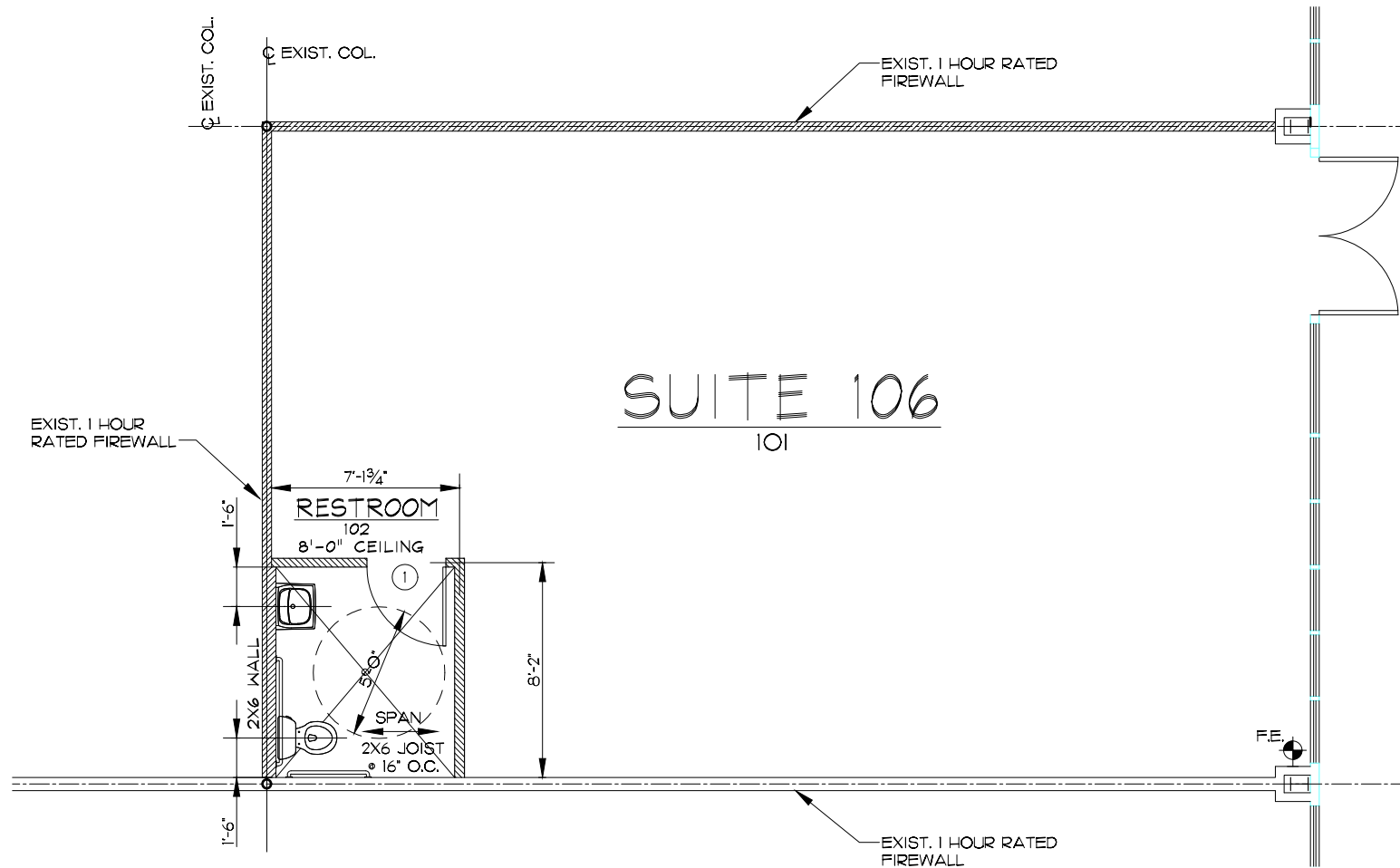



RETAIL

Barringer Crossing I

14241 Airline Highway
Baton Rouge, LA 70817

- 24,120 square foot inline retail building anchored by 216,720 square foot Barringer Foreman Technology Park
- Suite sizes starting at 2,000 square feet
- Great visibility, high traffic counts and abundant free parking



RETAIL SPACE

RETAIL BUILDING

14241 Airline Highway 24,120 SF

Out Parcel .5 Acres

TRAFFIC COUNT

Airline Highway: 31,538 vehicles/day

I-10 at Siegen Lane: 65,596 vehicles/day

DEMOGRAPHICS

	1 Mile	3 Miles	5 Miles
Population	2,089	47,731	117,000
Avg. Household Income	\$101,992	\$109,870	\$99,928



For more information on
Barringer Foreman Technology Park,
visit: sjpi.com/barringer





BARRINGER FOREMAN TECHNOLOGY PARK

BARRINGER CROSSING II

Barringer Crossing I

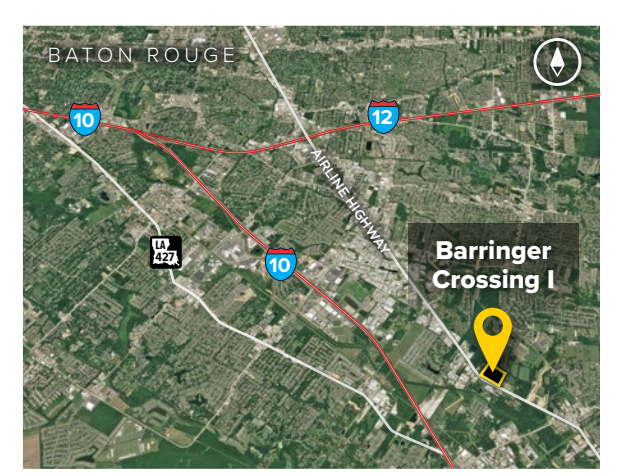

Distances to:

- Baton Rouge, LA (Downtown) 15 miles
- New Orleans, LA (Downtown) 70 miles
- I-10 at Highland Road 2 miles
- I-10 at Seigen Lane 3 miles
- I-12 at Airline Highway 5 miles
- New Orleans International Airport 60 miles
- Baton Rouge Metropolitan Airport 25 miles

About St. John Properties

St. John Properties, Inc. is a full-service real estate company headquartered in Baltimore, Maryland. The company owns, manages and has developed more than 19 million square feet of commercial real estate, including office, flex/R&D, warehouse, retail and residential space.



6473 Highway 44 | Suite 201
 Gonzales, LA 70737
 225.257.4821 | SJPI.COM/LOUISIANA
 MD | CO | LA | NV | PA | UT | VA | WI

For additional leasing information or to schedule a tour, contact:

Todd Pevey
Regional Partner, Louisiana
 225.571.1002
 tpevey@sjpi.com

Connect with us @stjohnprop    



This information contained in this publication has been obtained from sources believed to be reliable. St. John Properties makes no guarantee, warranty or representation about this information. Any projections, opinions, assumptions or estimates used here are for example only and do not represent the current or future performance of the property. Interested parties should conduct an independent investigation to determine whether the property suits their needs. REV 07/19