

**Total SF Available:**  
1,800 SF

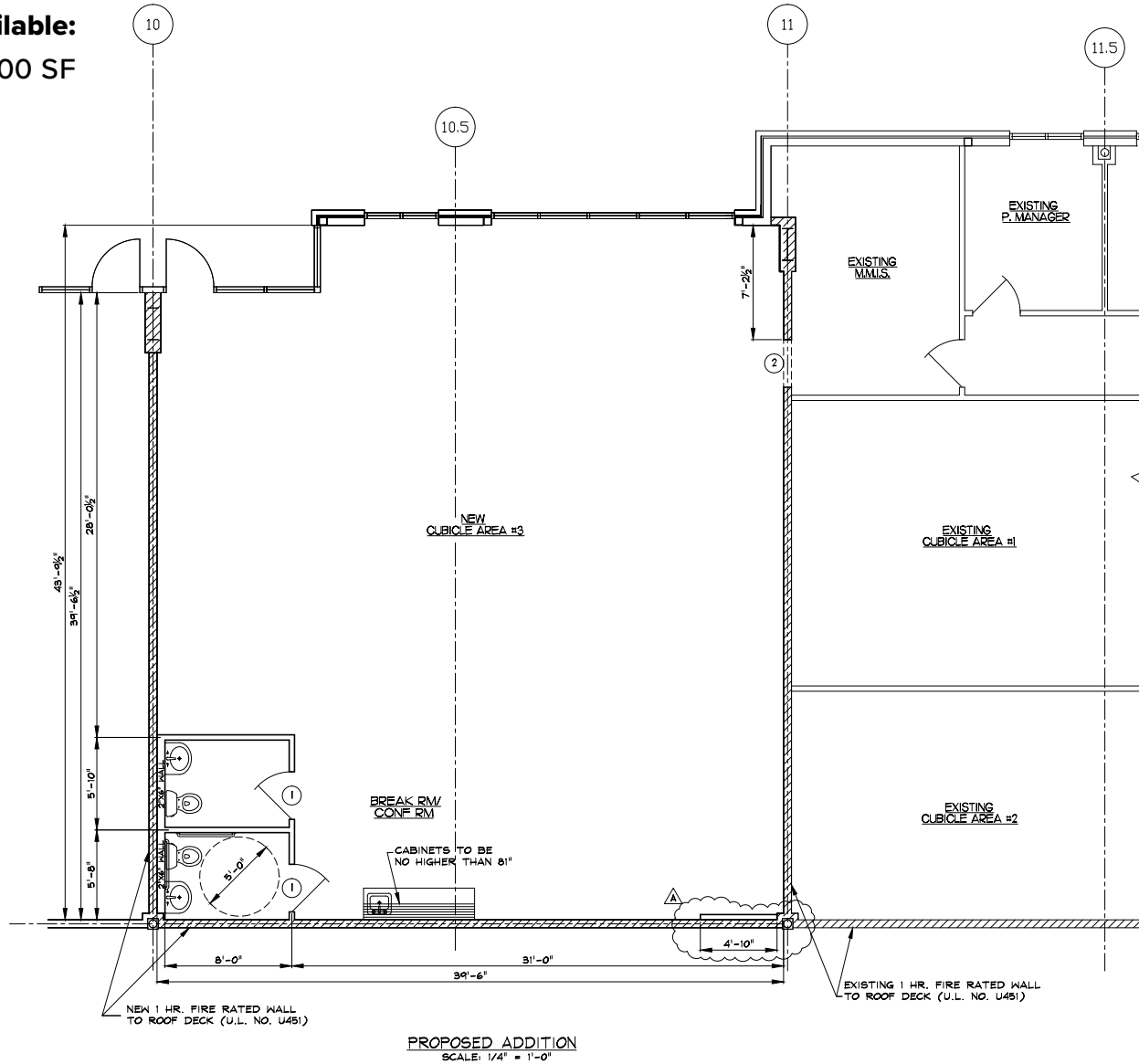

Note: This space plan is subject to existing field conditions. This drawing is proprietary and the exclusive property of St. John Properties, Inc. Any duplications, distribution, or other unauthorized use is strictly prohibited.

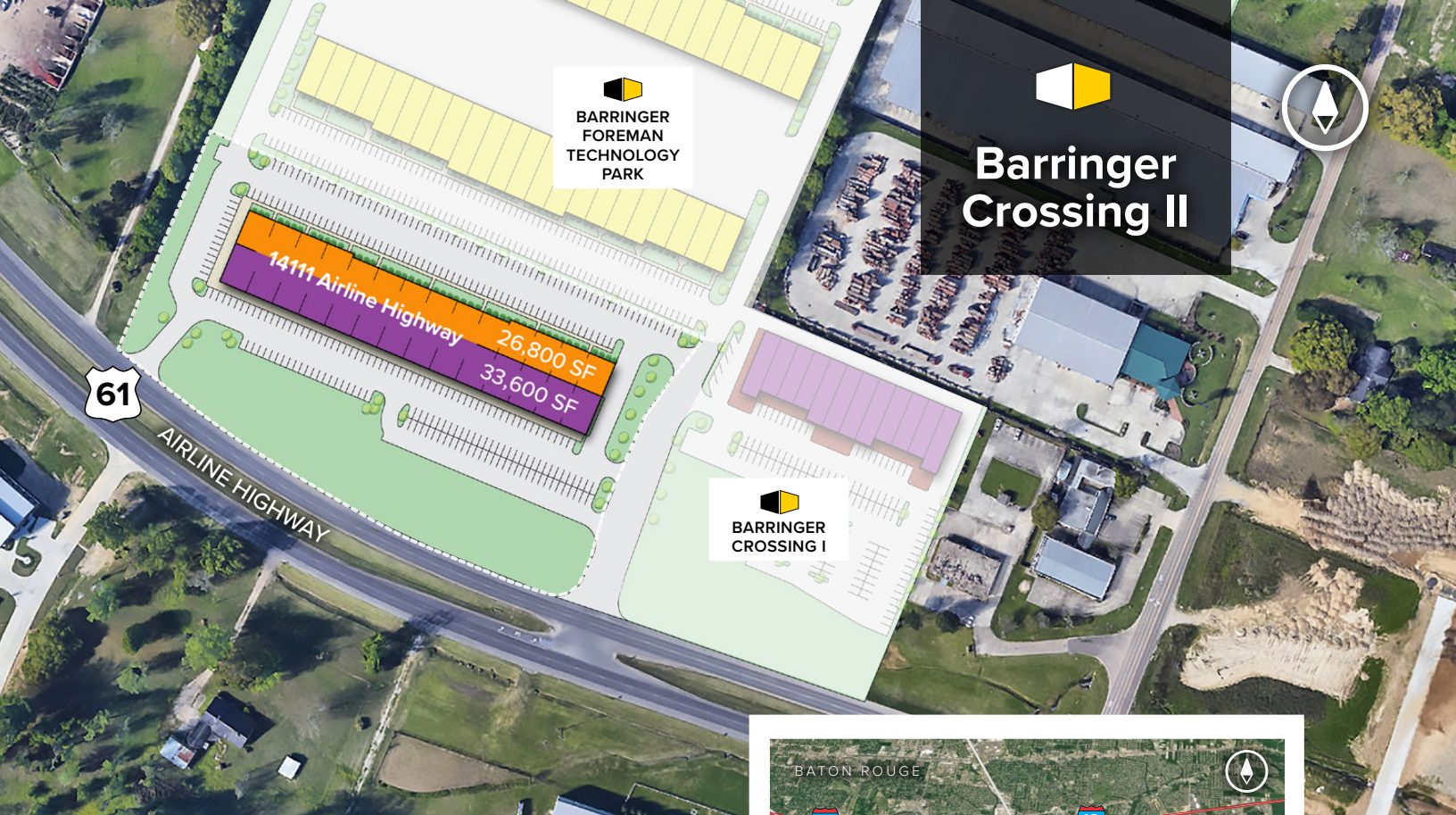



# Barringer Crossing II

### Distances to:

- Baton Rouge, LA (Downtown) ..... 15 miles
- New Orleans, LA (Downtown) ..... 70 miles
- Interstate 10 at Highland Road ..... 2 miles
- Interstate 10 at Seigen Lane ..... 3 miles
- Interstate 12 at Airline Highway ..... 5 miles
- New Orleans International Airport ..... 60 miles
- Baton Rouge Metropolitan Airport ..... 25 miles

### About St. John Properties

St. John Properties, Inc. is a full-service real estate company headquartered in Baltimore, Maryland. The company owns, manages and has developed more than 20 million square feet of commercial real estate, including office, flex/R&D, warehouse, retail and residential space.



6473 Highway 44 | Suite 201  
Gonzales, LA 70737

225.257.4821 | [SJPI.COM/LOUISIANA](http://SJPI.COM/LOUISIANA)

MD | CO | LA | NV | PA | UT | VA | WI

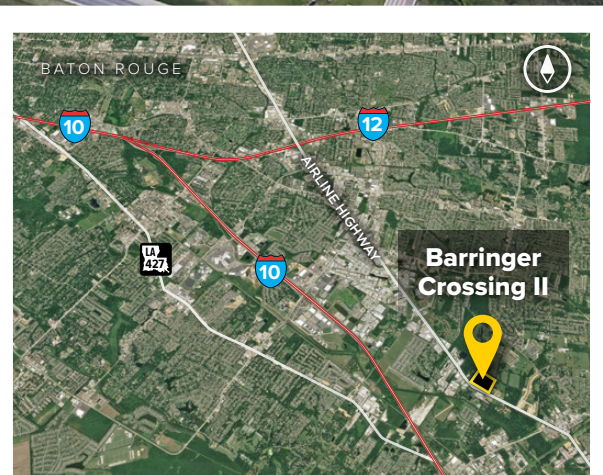

**For additional leasing information  
or to schedule a tour, contact:**

**Todd Pevey**  
Regional Partner, Louisiana  
225.571.1002  
[tpevey@sjpi.com](mailto:tpevey@sjpi.com)

Connect with us [@stjohnprop](https://www.instagram.com/stjohnprop)

This information contained in this publication has been obtained from sources believed to be reliable. St. John Properties makes no guarantee, warranty or representation about this information. Any projections, opinions, assumptions or estimates used here are for example only and do not represent the current or future performance of the property. Interested parties should conduct an independent investigation to determine whether the property suits their needs. REV 08/20