

TOTAL SF AVAILABLE:
2,800 SF

KEY PLAN
NOT TO SCALE

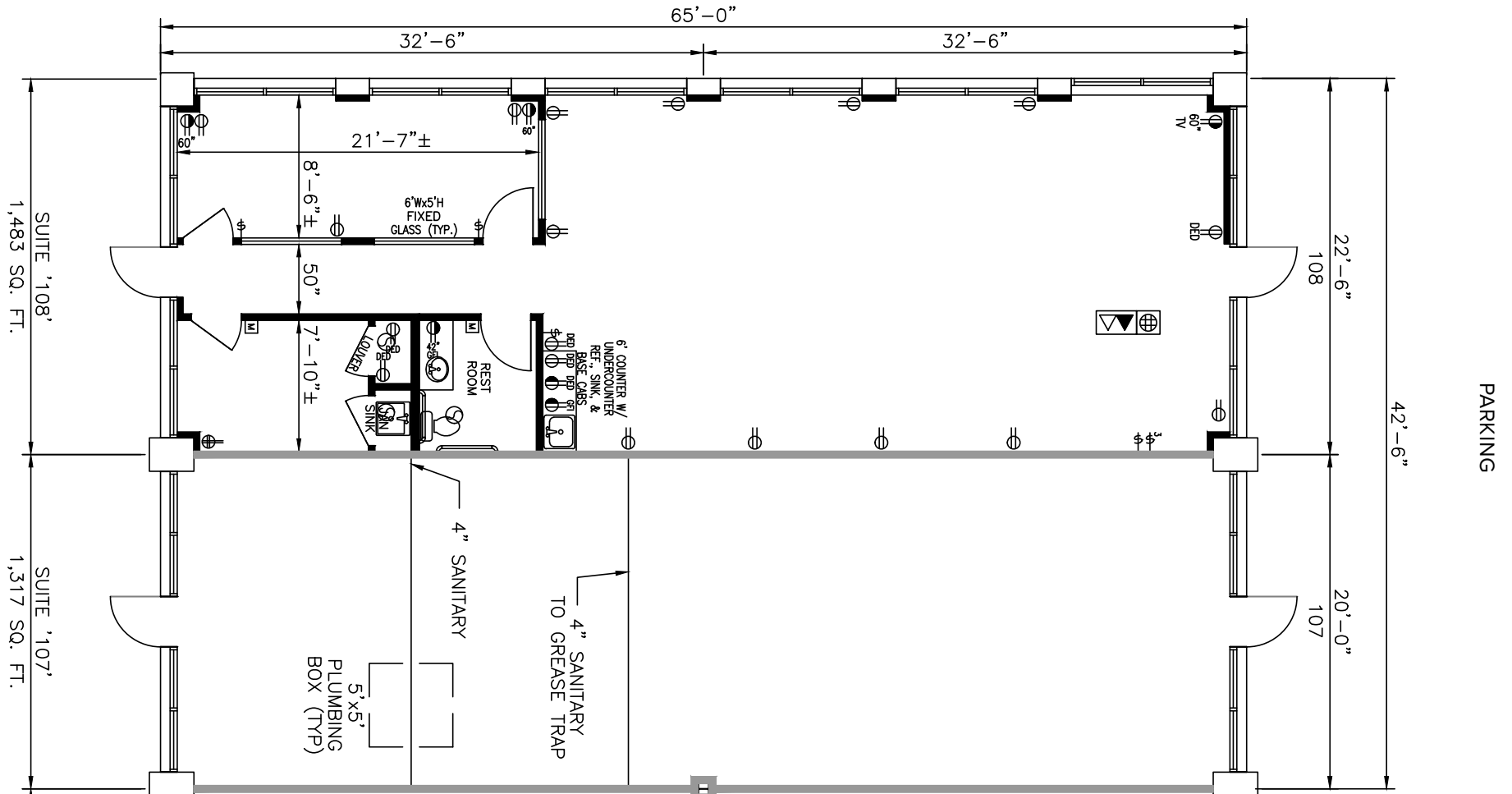
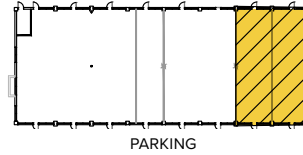

Note: This space plan is subject to existing field conditions. This drawing is proprietary and the exclusive property of St. John Properties, inc. Any duplications, distribution, or other unauthorized use is strictly prohibited.

About Cromwell Business Park

- Prime access and LED signage visible to 106,210 vehicles per day along I-97
- Great spot for quick-service restaurants
- 135-acre business community located directly off I-97 between Baltimore and Annapolis
- Adjacent to BWI Airport
- Easy access to I-97, I-95, I-895 & MD Routes 295, 100, and 176

TRAFFIC COUNT (MDOT)

Aviation Boulevard - 23,250 vehicles per day

I-97 (Electronic Sign) - 106,210 vehicles per day

DEMOGRAPHICS

	1 Mile	3 Miles	5 Miles
Population	6,679	77,359	201,349
Avg. Household Income	\$92,288	\$84,504	\$85,748



PAD SITES

PAD SITES

Pad Site A	2.0 Acres
Pad Site B	2.5 Acres
Pad Site C	1.0 Acres
Pad Site D	11.6 Acres



RETAIL TENANTS

910 CROMWELL PARK DRIVE

Suites 101-102	Starbucks	2,687 SF
Suite 103	AVAILABLE	1,631 SF
Suite 104	Allstate	1,004 SF
Suites 105-106	AVAILABLE	2,634 SF
Suites 107-108	AVAILABLE	2,800 SF

930 CROMWELL PARK DRIVE

Royal Farms

6930 AVIATION BOULEVARD

7-Eleven 2,940 SF

6934 AVIATION BOULEVARD

Suite A **AVAILABLE** 3,150 SF

Suite B **AVAILABLE** 3,532 SF

6938 AVIATION BOULEVARD

Suites A-C Los Portales 4,875 SF

Suite D Aviation Deli & Grill 1,625 SF

Suite E Subway 1,625 SF



Join Starbucks! 1,600-2,800 SF available

Seeking fast casual restaurants, salons, etc.

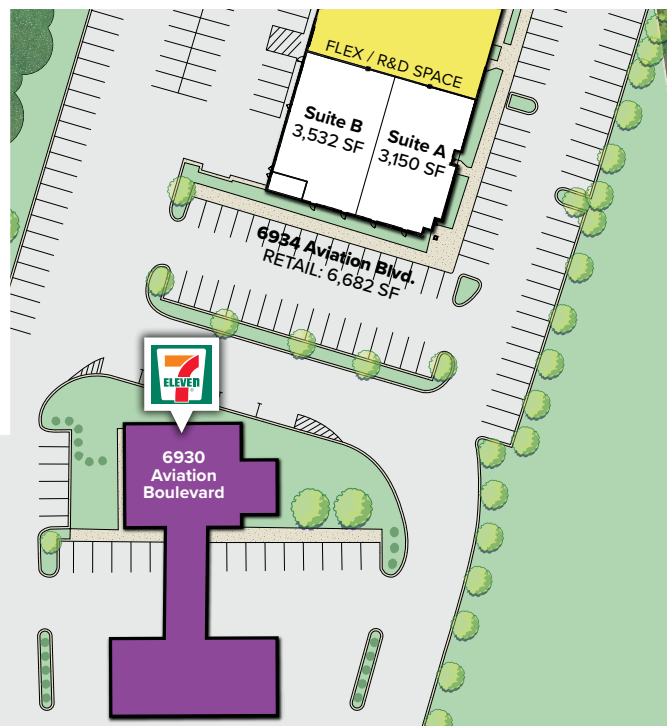
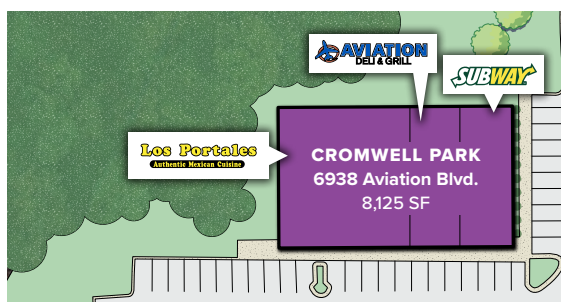
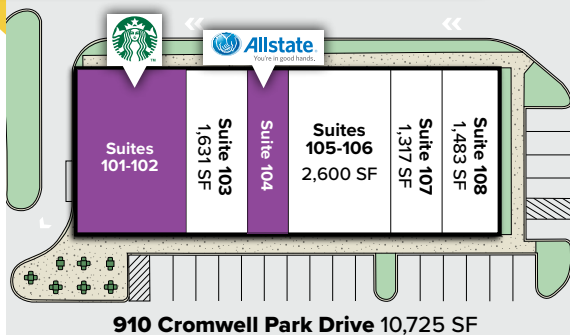



For more information on Cromwell Business Park visit: sjpi.com/cromwell

Distances to:

- Annapolis, MD 18 miles
- Baltimore, MD (Downtown) 10 miles
- BWI Airport 1.2 miles
- Columbia, MD 14 miles
- I-495 (Capital Beltway) 20 miles
- I-695 (Baltimore Beltway) 3 miles
- I-97 0.1 mile
- MD Rt. 295 4 miles
- Reagan National Airport 38 miles
- Washington, DC (Downtown) 33 miles



2560 Lord Baltimore Drive
 Baltimore, MD 21244
 410.788.0100 | SJPI.COM
 MD | CO | LA | NV | PA | UT | VA | WI

Connect with us @stjohnprop    

About St. John Properties

St. John Properties, Inc. is a full-service real estate company headquartered in Baltimore, Maryland. The company owns, manages and has developed more than 19 million square feet of commercial real estate, including office, flex/R&D, warehouse, retail and residential space.

For additional leasing information or to schedule a tour, contact:

Eric Llewellyn
 Retail Leasing Representative
 443.464.1308 | ellewellyn@sjpi.com

Bill Holzman
 Vice President, Retail Leasing
 410.369.1240 | bholzman@sjpi.com



This information contained in this publication has been obtained from sources believed to be reliable. St. John Properties makes no guarantee, warranty or representation about this information. Any projections, opinions, assumptions or estimates used here are for example only and do not represent the current or future performance of the property. Interested parties should conduct an independent investigation to determine whether the property suits their needs. REV 05/19