

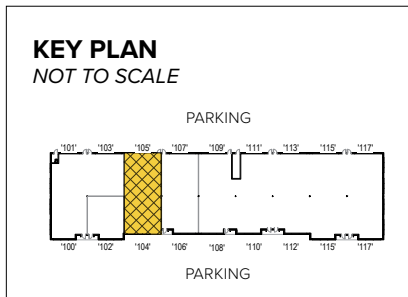

**Total SF Available:**

2,581 SF

*New, shell condition with rear view of forest*



**Note:** This space plan is subject to existing field conditions. This drawing is proprietary and the exclusive property of St. John Properties, Inc. Any duplications, distribution, or other unauthorized use is strictly prohibited.

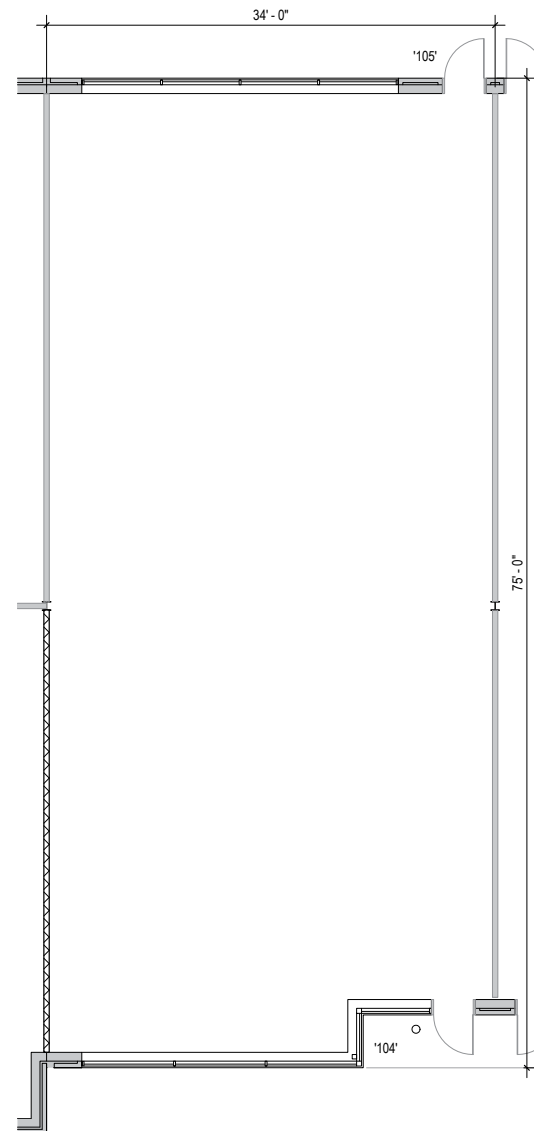

### Single-Story Office Space

405 Williams Court	31,280 SF	
415 Williams Court	25,045 SF	
425 Williams Court	31,280 SF	
435 Williams Court	40,800 SF	<b>LEED SILVER</b>
1 Stirling Street	27,540 SF	FUTURE
2 Stirling Street	20,400 SF	FUTURE
11 Stirling Street	27,540 SF	FUTURE
12 Stirling Street	20,400 SF	FUTURE
31 Stirling Street	20,400 SF	FUTURE
1 Irondale Street	22,780 SF	FUTURE
2 Irondale Street	21,760 SF	FUTURE
11 Irondale Street	20,400 SF	FUTURE
10 Irondale Street	36,040 SF	<b>LEED GOLD</b>
12 Irondale Street	36,040 SF	<b>LEED GOLD</b>
11501 Wakefield Street	16,320 SF	FUTURE
11511 Wakefield Street	16,320 SF	FUTURE
11560 Crossroads Circle	23,630 SF	<b>LEED SILVER</b>
11570 Crossroads Circle	25,160 SF	<b>LEED SILVER</b>

LEED (select buildings)	Core & shell
Suite Sizes	1,384 up to 40,800 SF
Ceiling Height	10 ft. clear minimum
Offices	Built to suit
Parking	5 spaces per 1,000 SF
HVAC	Gas
Roof	EPDM or TPO
Exterior Walls	Brick on block
Zoning	ML-IM-M43

Single-story class 'A' office exterior

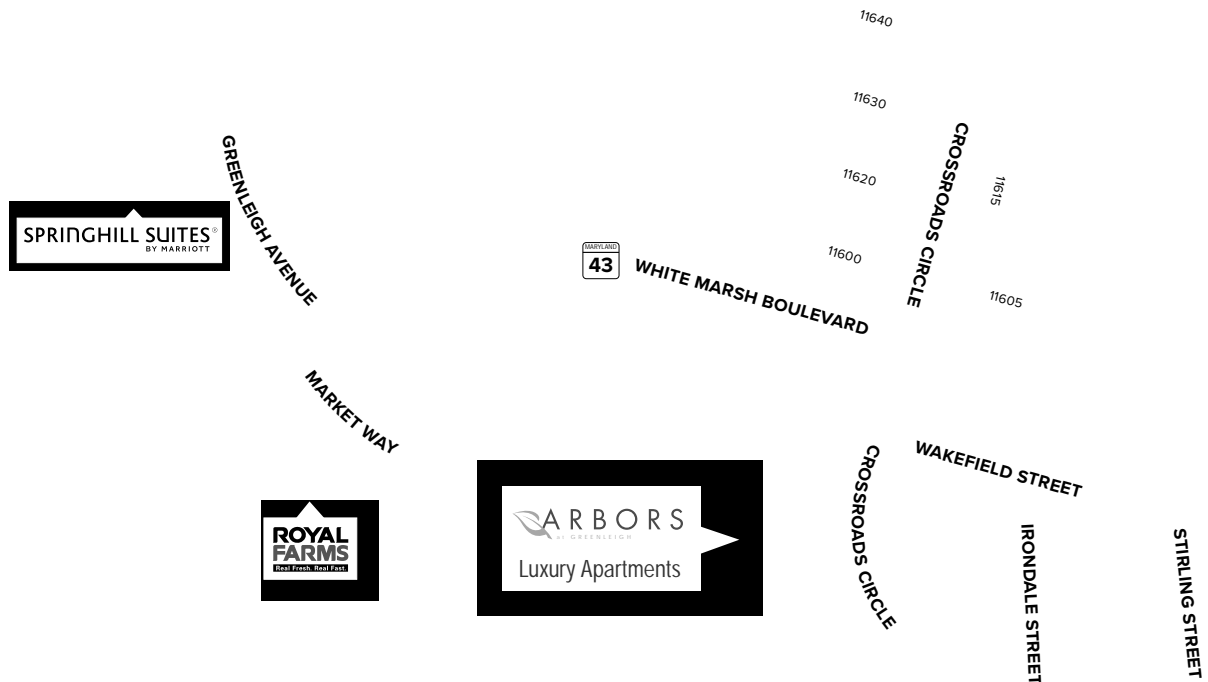



Scan with your mobile device to take a virtual tour, download floor plans and more!

# Contact Us

For additional leasing information or to schedule a tour, contact:

### RETAIL SPACE:

**Bill Holzman**

Vice President, Retail Leasing

bholzman@sjpi.com

410.369.1240

**Eric Llewellyn**

Retail Leasing Representative

ellewellyn@sjpi.com

443.464.1308

### OFFICE/FLEX SPACE:

**Matt Lenihan**

Vice President, Leasing

mlehan@sjpi.com

410.369.1202

### Corporate Headquarters:

2560 Lord Baltimore Drive, Baltimore, MD 21244

**410.788.0100 | SJPI.COM**

### About St. John Properties

St. John Properties, Inc. is a full-service real estate company headquartered in Baltimore, Maryland. The company owns, manages and has developed more than 21 million square feet of commercial real estate, including office, flex/R&D, warehouse, retail and residential space.

Connect with us @stjohnprop



This information contained in this publication has been obtained from sources believed to be reliable. St. John Properties makes no guarantee, warranty or representation about this information. Any projections, opinions, assumptions or estimates used here are for example only and do not represent the current or future performance of the property. Interested parties should conduct an independent investigation to determine whether the property suits their needs. REV 09/21