



410.788.0100 | SJPI.COM

Greenleigh

425 Williams Court | Middle River, MD 21220

Suites 100-120



Total SF Available:
17,915 up to 31,280 SF

Open ceiling, open office plan with upgraded fit out; modern, collaborative design ideal for tech company; full-building available

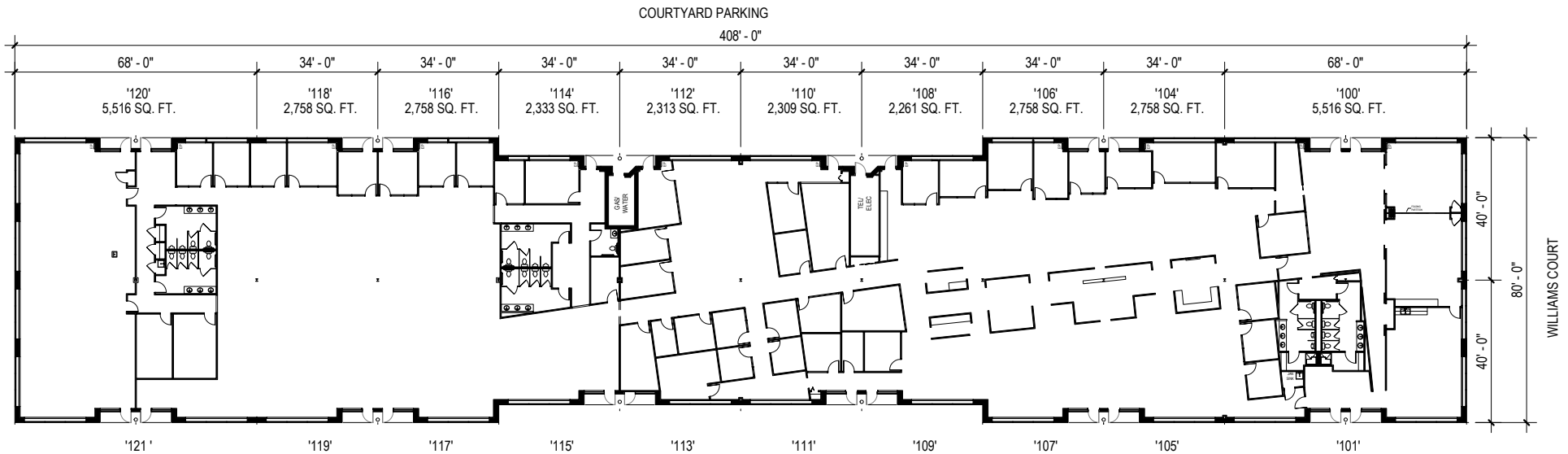

Note: This space plan is subject to existing field conditions. This drawing is proprietary and the exclusive property of St. John Properties, Inc. Any duplications, distribution, or other unauthorized use is strictly prohibited.

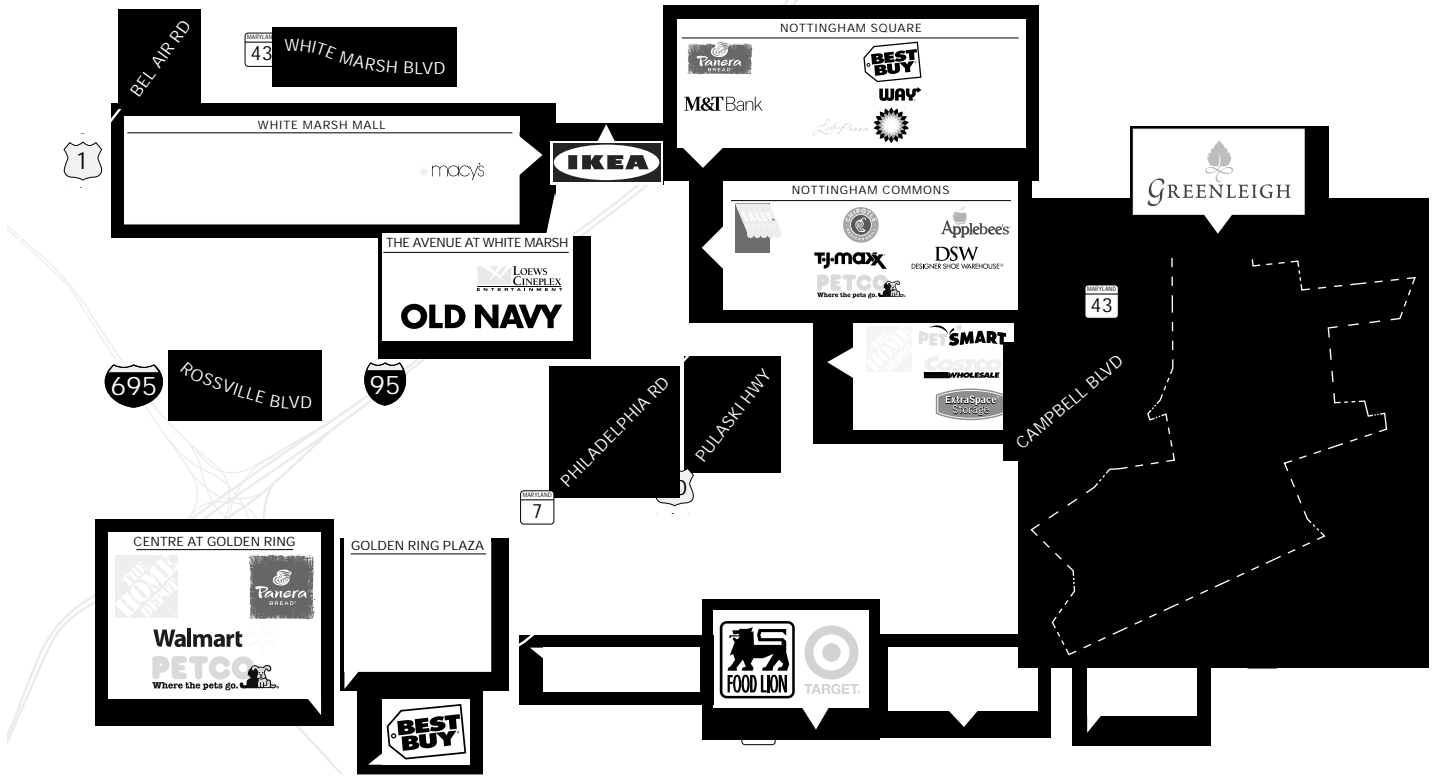

Distances to:

- Aberdeen, MD 18 miles
- Amtrak/MARC Station 1 mile
- Baltimore, MD (Downtown) 11 miles
- BWI Airport 20 miles
- Interstate 95 2 miles
- Interstate 695 (Baltimore Beltway) 4 miles
- Martin State Airport 1 mile
- Towson, MD 10 miles

About St. John Properties

St. John Properties, Inc. is a full-service real estate company headquartered in Baltimore, Maryland. The company owns, manages and has developed more than 21 million square feet of commercial real estate, including office, flex/R&D, warehouse, retail and residential space.



2560 Lord Baltimore Drive
 Baltimore, MD 21244
 410.788.0100 | SJPI.COM
 MD | CO | LA | NV | PA | UT | VA | WI

Connect with us @stjohnprop



For additional leasing information or to schedule a tour, contact:

OFFICE / FLEX SPACE
 Matt Lenihan
 Vice President, Leasing
 410.369.1202 | mlenihan@sjpi.com

Brook Harlander
 Partner in Training
 410.369.1232 | bharlander@sjpi.com

RETAIL SPACE
 Bill Holzman
 Vice President, Retail Leasing
 410.369.1240 | bholzman@sjpi.com

Eric Llewellyn
 Retail Leasing Representative
 443.464.1308 | ellewellyn@sjpi.com

This information contained in this publication has been obtained from sources believed to be reliable. St. John Properties makes no guarantee, warranty or representation about this information. Any projections, opinions, assumptions or estimates used here are for example only and do not represent the current or future performance of the property. Interested parties should conduct an independent investigation to determine whether the property suits their needs. REV 03/21