

**TOTAL SF AVAILABLE:**  
144 - 168 SF

NOTE: THIS SPACE PLAN IS SUBJECT TO EXISTING FIELD CONDITIONS. THIS DRAWING IS PROPRIETARY AND THE EXCLUSIVE PROPERTY OF ST. JOHN PROPERTIES, INC. ANY DUPLICATIONS, DISTRIBUTION, OR OTHER UNAUTHORIZED USE IS STRICTLY PROHIBITED.

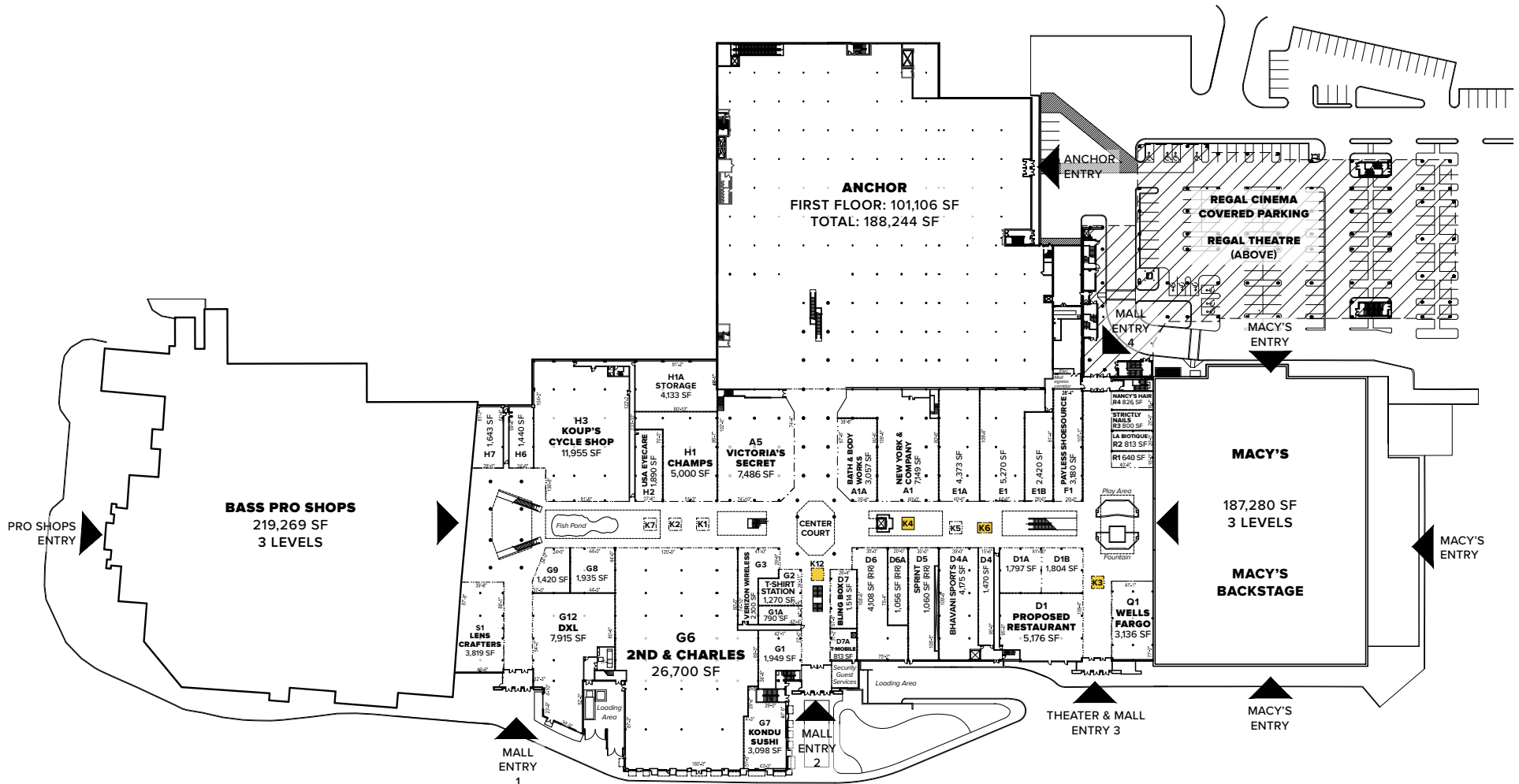

**TOTAL SF AVAILABLE:**  
150 - 192 SF

NOTE: THIS SPACE PLAN IS SUBJECT TO EXISTING FIELD CONDITIONS. THIS DRAWING IS PROPRIETARY AND THE EXCLUSIVE PROPERTY OF ST. JOHN PROPERTIES, INC. ANY DUPLICATIONS, DISTRIBUTION, OR OTHER UNAUTHORIZED USE IS STRICTLY PROHIBITED.

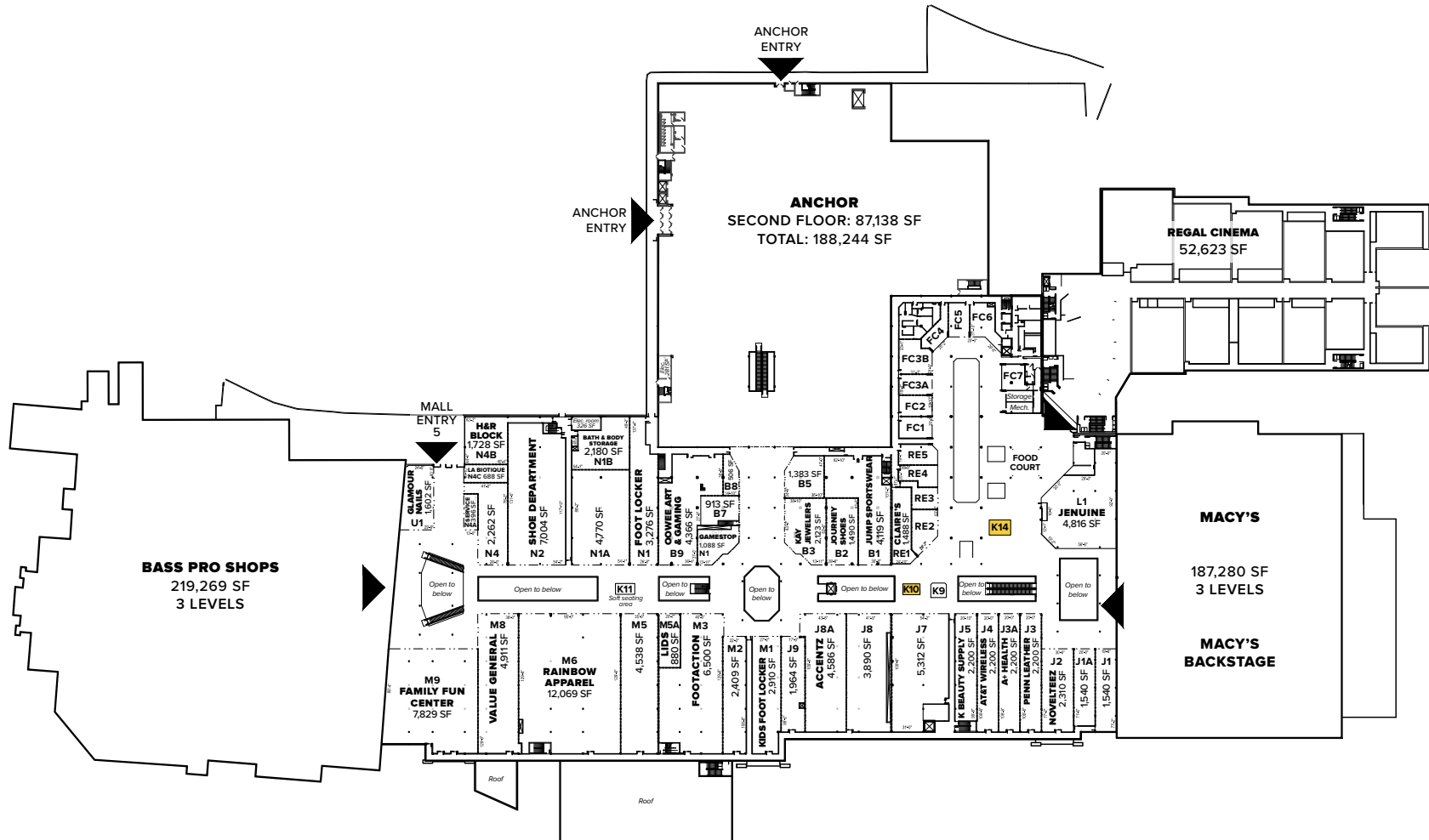



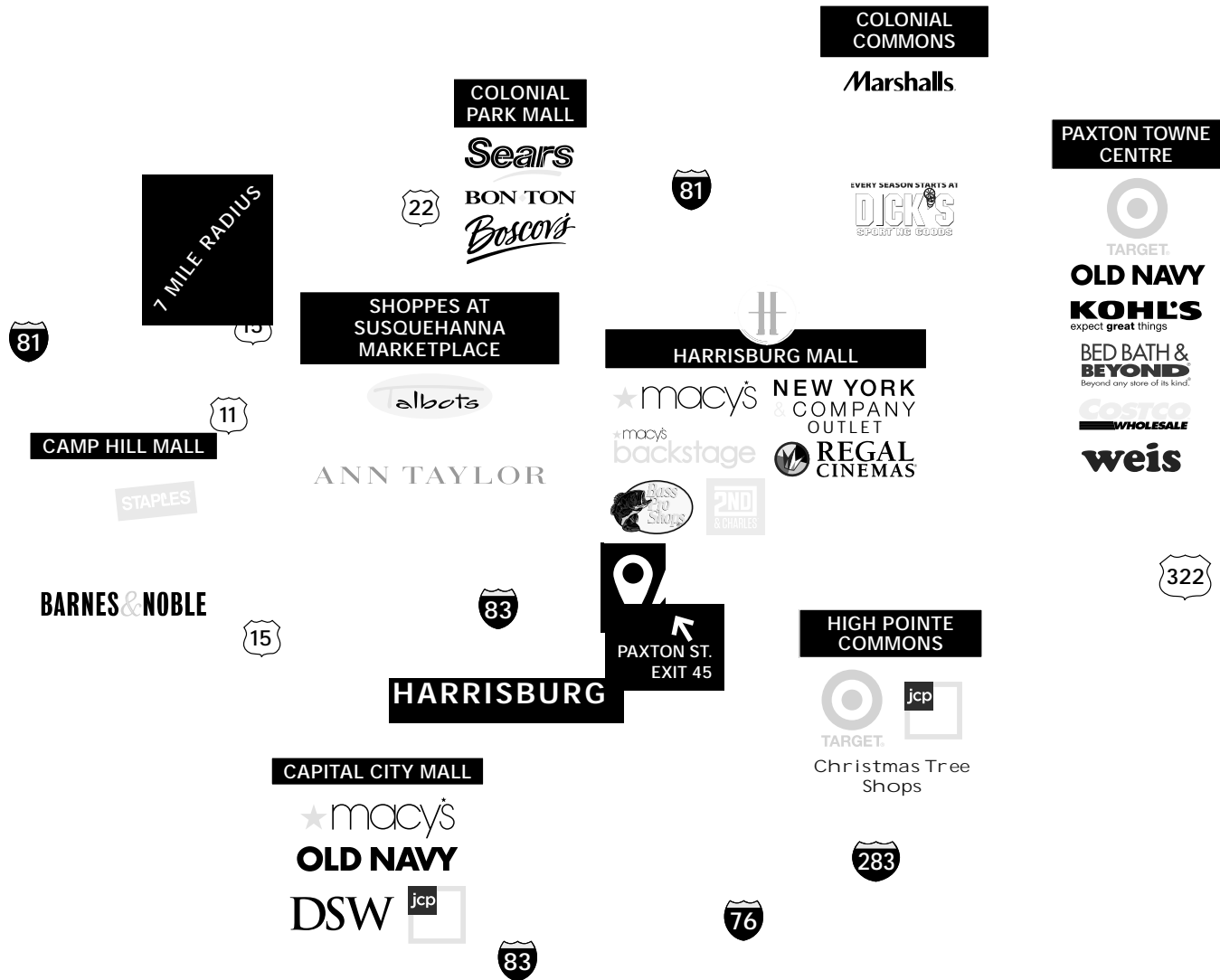

### DEMOGRAPHICS

	Population	Households	Average Income
1 Mile	9,208	3,307	\$65,056
3 Miles	85,124	35,118	\$59,300
5 Miles	176,942	75,963	\$68,570
7 Miles	270,072	113,162	\$76,950

### PROPERTY DATA

Annual Visitors	4 million
Site	60.05 acres
Parking	4,059 spaces
Total Stores	70
Levels	2

For additional leasing information or to schedule a tour, contact:

**Bill Holzman**  
Vice President, Retail Leasing  
410.369.1240 | bholzman@sjpi.com

**Eric Llewellyn**  
Leasing Representative  
443.464.1308 | ellewellyn@sjpi.com

For more information on Harrisburg Mall, visit:  
[sjpi.com/harrisburgmall](http://sjpi.com/harrisburgmall)

Owned & Managed by:



2560 Lord Baltimore Drive  
Baltimore, MD 21244

410.788.0100 | SJPI.COM

MD | CO | LA | NV | PA | UT | VA | WI