

**TOTAL SF AVAILABLE:**  
518 - 5,312 SF

NOTE: THIS SPACE PLAN IS SUBJECT TO EXISTING FIELD CONDITIONS. THIS DRAWING IS PROPRIETARY AND THE EXCLUSIVE PROPERTY OF ST. JOHN PROPERTIES, INC. ANY DUPLICATIONS, DISTRIBUTION, OR OTHER UNAUTHORIZED USE IS STRICTLY PROHIBITED.

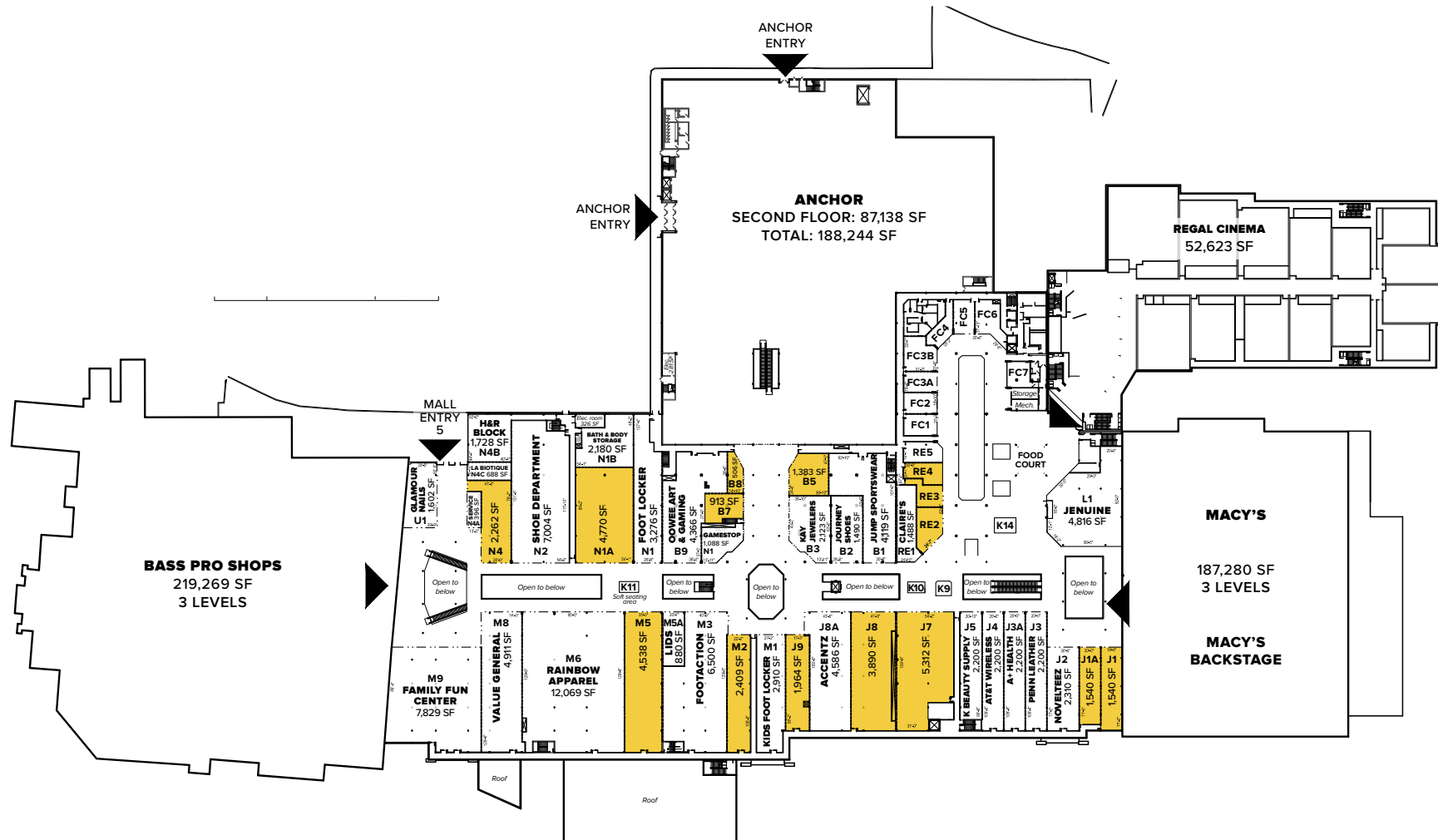





### DEMOGRAPHICS

	Population	Households	Average Income
1 Miles	9,260	3,334	\$66,406
3 Miles	85,333	35,215	\$59,208
5 Miles	177,007	75,952	\$67,207
7 Miles	269,675	112,966	\$74,610

### PROPERTY DATA

Annual Visitors	4 million
Site	60.05 acres
Parking	4,059 spaces
Total Stores	70
Levels	2

For additional leasing information or to schedule a tour, contact:

Bill Holzman *VP, Retail Leasing*  
410.369.1240 | bholzman@sjpi.com

Brooke Harlander *Leasing Agent*  
410.369.1232 | bharlander@sjpi.com

For more information on Harrisburg Mall, visit:  
[sjpi.com/harrisburgmall](http://sjpi.com/harrisburgmall)

Owned & Managed by:



2560 Lord Baltimore Drive  
Baltimore, MD 21244  
410.788.0100 | SJPI.COM

CO | MD | NV | PA | LA | UT | VA | WI

This information contained in this publication has been obtained from sources believed to be reliable. St. John Properties makes no guarantee, warranty or representation about this information. Any projections, opinions, assumptions or estimates used here are for example only and do not represent the current or future performance of the property. Interested parties should conduct an independent investigation to determine whether the property suits their needs. REV 1217