

**Total SF Available:**  
3,000 SF

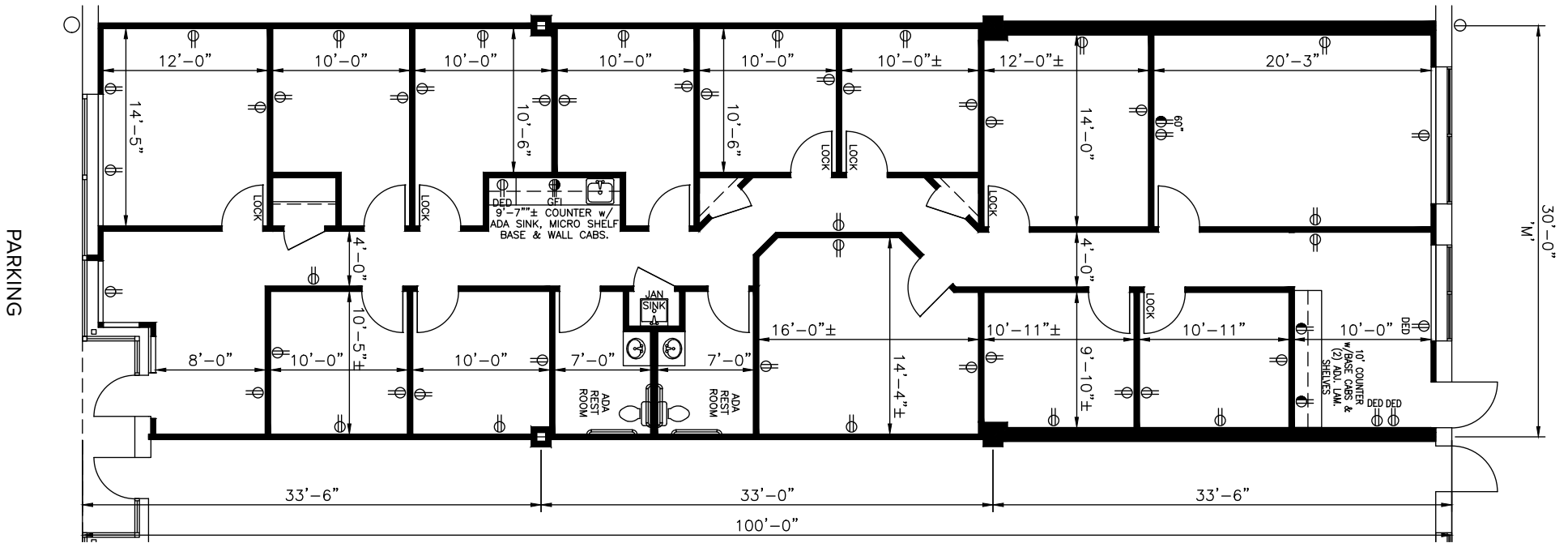
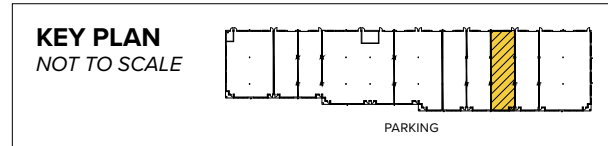

## About Maple Lawn Corporate Center

Maple Lawn Corporate Center is a 20-acre business park within the Maple Lawn mixed-use community. The corporate center includes five single story flex/R&D buildings totaling 210,100 square feet.

## About Maple Lawn

Maple Lawn is located off Route 29 in the Washington-Baltimore corridor. Maple Lawn is a mixed-use community built on the principles of Traditional Neighborhood Development. Residents and visitors can walk to shops, services and even to work.

The community includes corporate offices and professional/medical buildings, as well as residential: six neighborhoods with a total of 1,452 homes planned. Located in Howard County, this mixed-use community has become a distinctive corporate address. Maple Lawn is a headquarters-quality location, strategically positioned between Washington, D.C. and Baltimore.

In partnership with:  **GREENEBAUM**  
ENTERPRISES

## Flex/Office Space

### Flex/Office Buildings

11820 West Market Place	39,620 SF	<b>LEED SILVER</b>
11830 West Market Place	42,620 SF	<b>LEED GOLD</b>
11840 West Market Place	42,620 SF	<b>LEED GOLD</b>
11850 West Market Place	42,620 SF	<b>LEED GOLD</b>
11860 West Market Place	42,620 SF	<b>LEED GOLD</b>

### Flex/Office Specifications

LEED	Core & shell
Suite Sizes	2,520 up to 42,620 SF
Ceiling Height	16 ft. clear minimum
Offices	Built to suit
Parking	4 spaces per 1,000 SF
Heat	Gas
Roof	EPDM Rubber
Exterior Walls	Brick on block
Loading	Dock or drive-in
Zoning	MXD-3



11820 West Market Place

11830 West Market Place

11840 West Market Place

11850 West Market Place

11860 West Market Place

*For more information on  
Maple Lawn Corporate Center,  
visit: [sjpi.com/maplelawn](http://sjpi.com/maplelawn) ex*

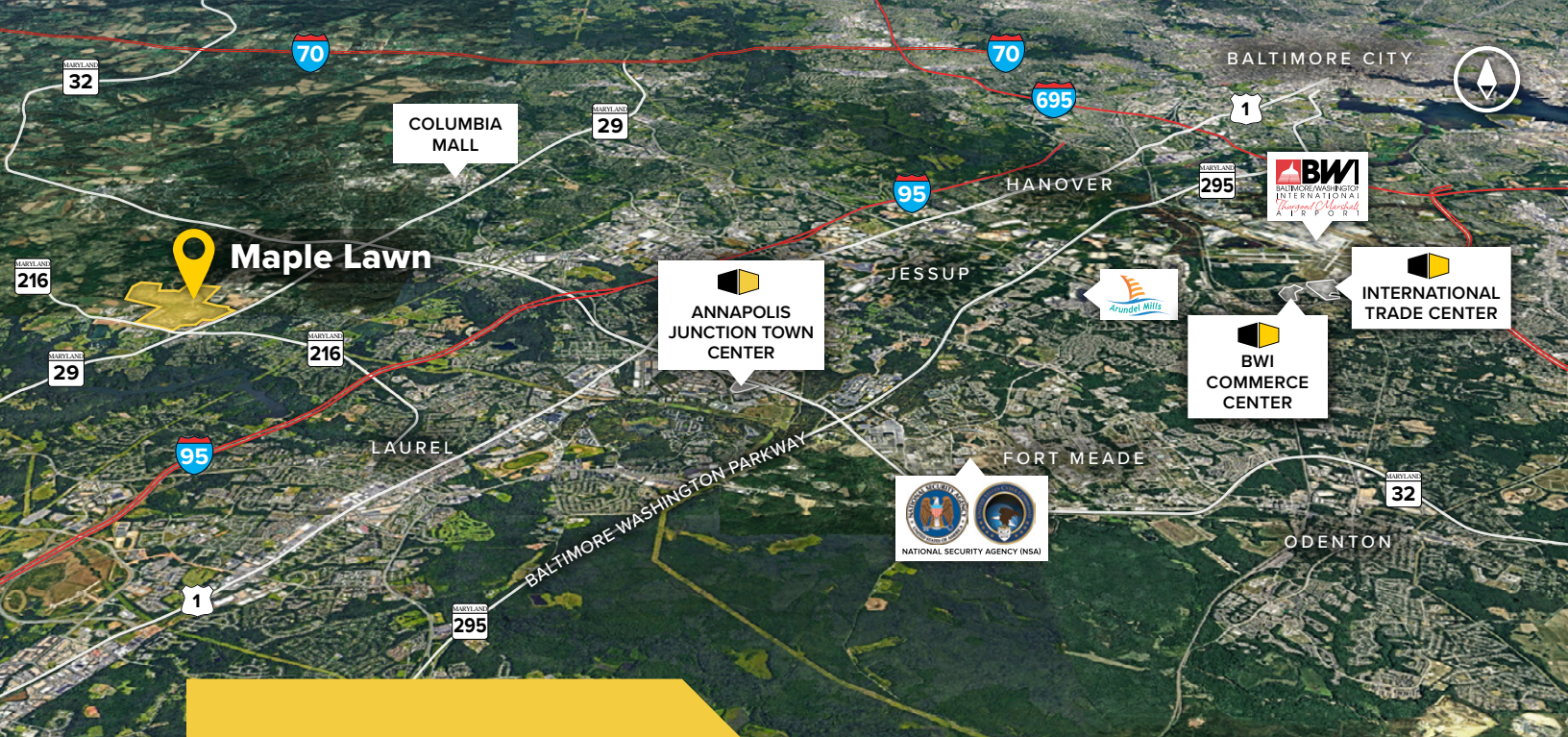

**For additional leasing information or to schedule a tour, contact:**

**Bill Jautze**  
*Leasing Representative*  
 410.369.1213 | bjautze@sjpi.com

**Sean Doordan**  
*Senior VP, Leasing & Acquisitions*  
 410.369.1211 | sdoordan@sjpi.com

**About St. John Properties**

St. John Properties, Inc. is a full-service real estate company headquartered in Baltimore, Maryland. The company owns, manages and has developed nearly 20 million square feet of commercial real estate, including office, flex/R&D, warehouse, retail and residential space.

**Distances to:**

- Annapolis, MD (Downtown) ..... 31 miles
- Baltimore, MD (Downtown) ..... 22 miles
- BWI Airport ..... 19 miles
- Columbia, MD ..... 6 miles
- Interstate 95 ..... 3 miles
- Interstate 295 (Balto.-Wash. Pkwy) ..... 8 miles
- Interstate 495 (Capital Beltway) ..... 10 miles
- Interstate 695 (Baltimore Beltway) ..... 16 miles
- Intercounty Connector (ICC) ..... 4.5 miles
- MD Route 29 ..... 0.5 mile
- MD Route 32 ..... 2.7 miles
- NIH ..... 25 miles
- NSA/Fort Meade ..... 9 miles
- Washington, D.C. (Downtown) ..... 28 miles



2560 Lord Baltimore Drive  
 Baltimore, MD 21244  
**410.788.0100 | SJPI.COM**  
 MD | CO | LA | NV | PA | UT | VA | WI

Connect with us @stjohnprop    



*This information contained in this publication has been obtained from sources believed to be reliable. St. John Properties makes no guarantee, warranty or representation about this information. Any projections, opinions, assumptions or estimates used here are for example only and do not represent the current or future performance of the property. Interested parties should conduct an independent investigation to determine whether the property suits their needs. REV 06/20*