

**MAPLE LAWN MULTI-STORY OFFICE**  
11810 West Market Place | Fulton, MD 20759  
First Floor

**TOTAL SF AVAILABLE:**  
2,242-8,292 SF

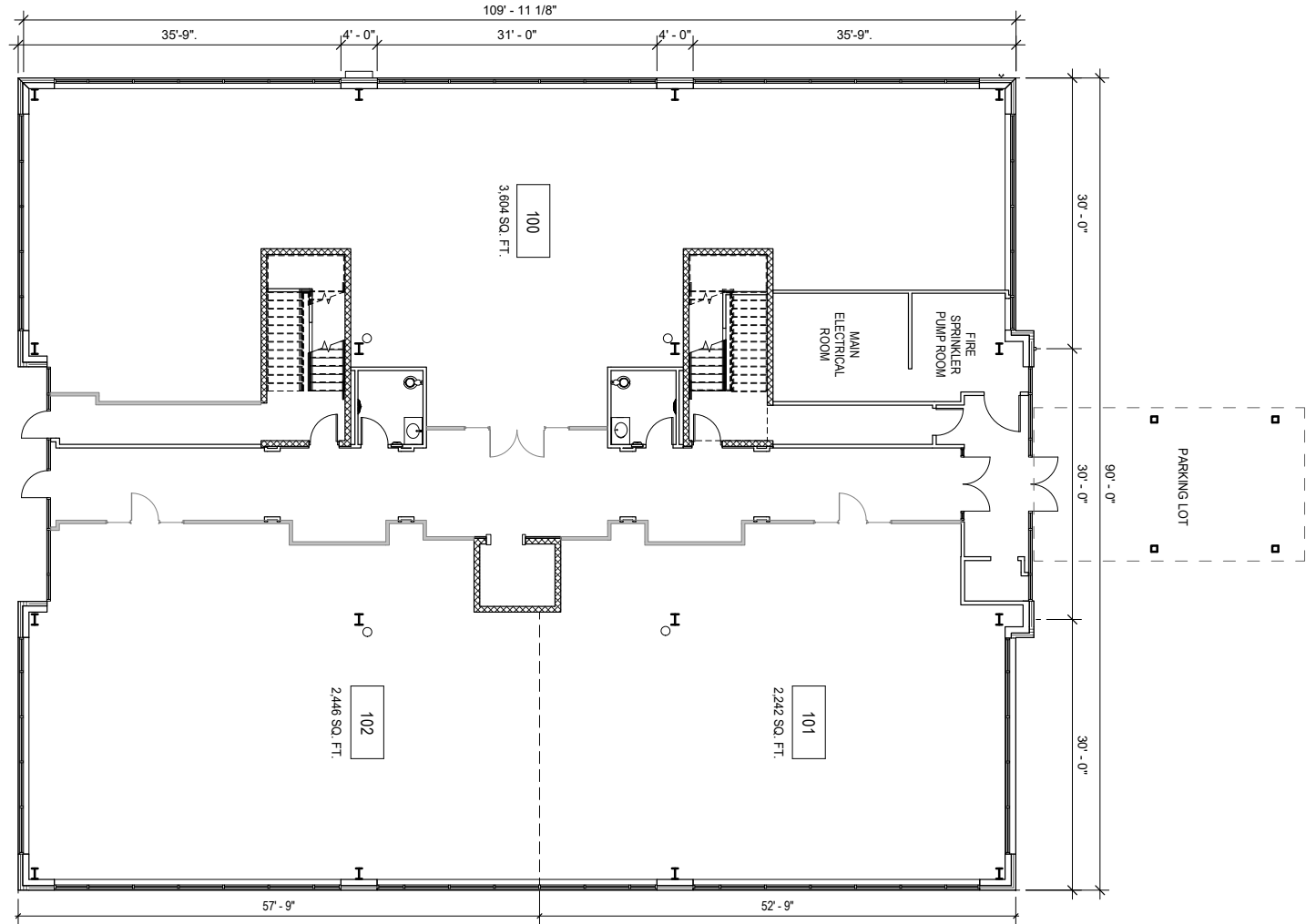

11860 WEST MARKET PLACE

# 11820-11860 West Market Place

Flex/R&D • Five buildings totaling 210,100 Sq. Ft.



11820 West Market Place	39,620 SF
11830 West Market Place	42,620 SF
11840 West Market Place	42,620 SF
11850 West Market Place	42,620 SF
11860 West Market Place	42,620 SF

FLEX / R&D SPECIFICATIONS	
LEED Registered	Core and Shell
Ceiling Height	16 ft. clear minimum
Loading	Dock or drive-in
Suite Sizes	2,520 - 42,620 SF
Roof	EPDM Rubber
Walls	Brick on Block
Parking	4 per 1,000 SF
Heat	Gas
Zoning	MXD-3



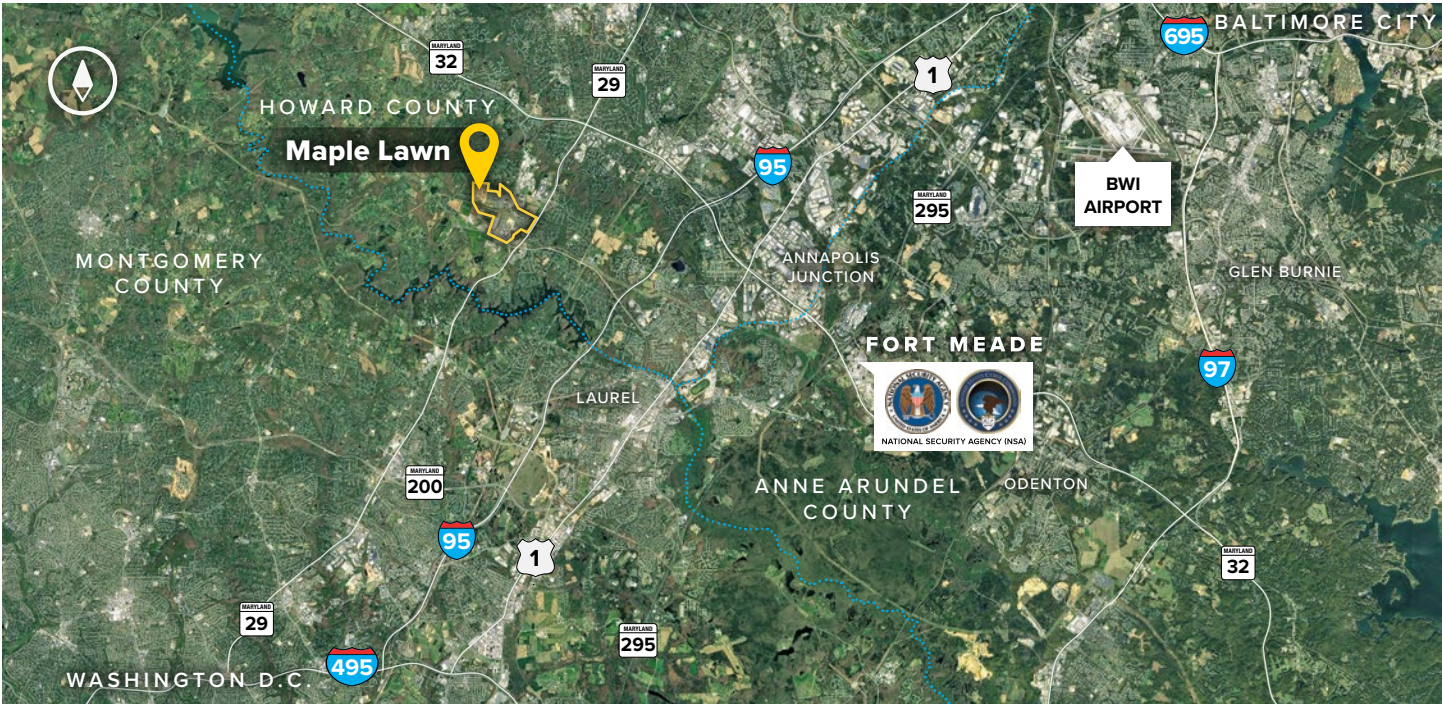

**Distances to:**

AMTRAK .....	20 miles
Annapolis (Downtown) .....	31 miles
Baltimore (Downtown) .....	22 miles
BWI Airport .....	19 miles
Columbia (Downtown) .....	6 miles
I-95 .....	3 miles
I-495 (Capital Beltway) .....	10 miles
I-695 (Baltimore Beltway) .....	16 miles
Inter-County Connector (ICC) .....	4.5 miles
JHU APL .....	1 mile
MD Rt. 29 .....	0.5 mile
MD-295 (Balt-Wash. Pkwy) .....	8 miles
MD Rt. 32 .....	2.7 miles
NIH .....	25 miles
NSA and Ft. Meade .....	9 miles
Reagan-National Airport .....	32 miles
Washington-Dulles Intl. Airport .....	44 miles
Washington, D.C. (Downtown) .....	28 miles

**About St. John Properties**

St. John Properties, Inc. is a full-service real estate company headquartered in Baltimore, Maryland. The company owns, manages and has developed more than 19 million square feet of commercial real estate, including office, flex/R&D, warehouse, retail and residential space.

**For additional leasing information or to schedule a tour, contact:**

**Claire Cobert**  
*Leasing Representative*  
 410.369.1274 | ccobert@sjpi.com

**Richard Williamson**  
*Senior VP, Leasing & Marketing*  
 410.369.1222 | rwilliamson@sjpi.com

Master Developer: **GREENEBAUM ENTERPRISES**



2560 Lord Baltimore Drive  
 Baltimore, MD 21244  
 410.788.0100 | SJPI.COM

CO | MD | NV | PA | LA | UT | VA | WI

Connect with us @stjohnprop



*This information contained in this publication has been obtained from sources believed to be reliable. St. John Properties makes no guarantee, warranty or representation about this information. Any projections, opinions, assumptions or estimates used here are for example only and do not represent the current or future performance of the property. Interested parties should conduct an independent investigation to determine whether the property suits their needs. REV 10/18*