

TOTAL SF AVAILABLE:
4,556 SF

KEY PLAN
NOT TO SCALE

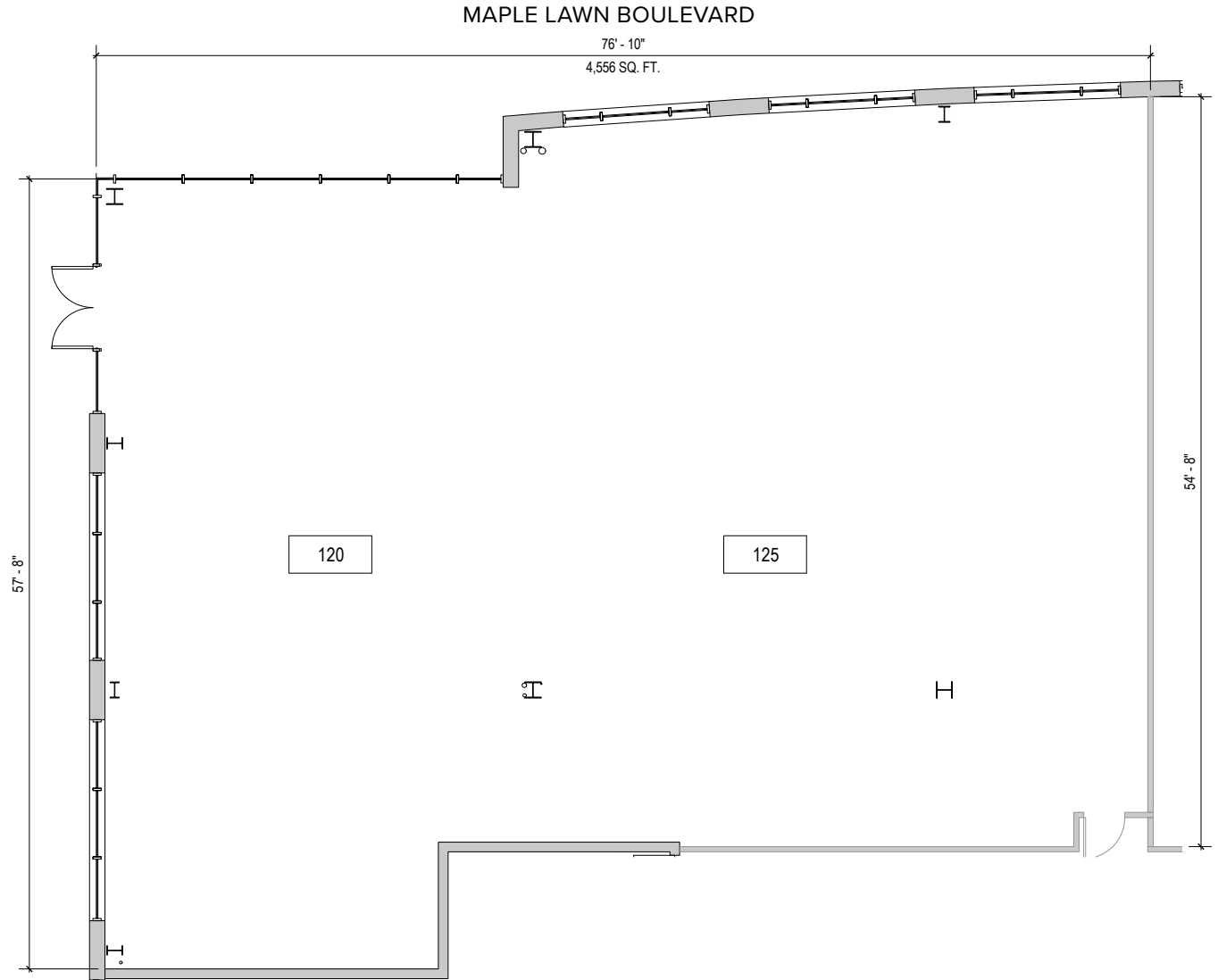

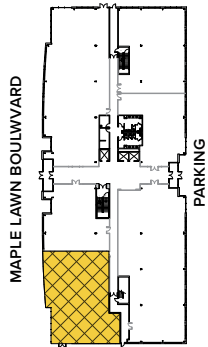

8115 Maple Lawn Boulevard

Four-Story Class 'A' Office • 130,629 Sq. Ft.

| CLASS 'A' OFFICE SPECIFICATIONS | |
|---------------------------------|----------------------------|
| HVAC | Gas, VAV with zone control |
| Lease Type | Full Service |
| Office | Build to suit |
| Parking | 4 spaces per 1,000 SF |
| Suite Sizes | 2,500 - 130,629 SF |
| Elevator | Yes |
| LEED | Gold |



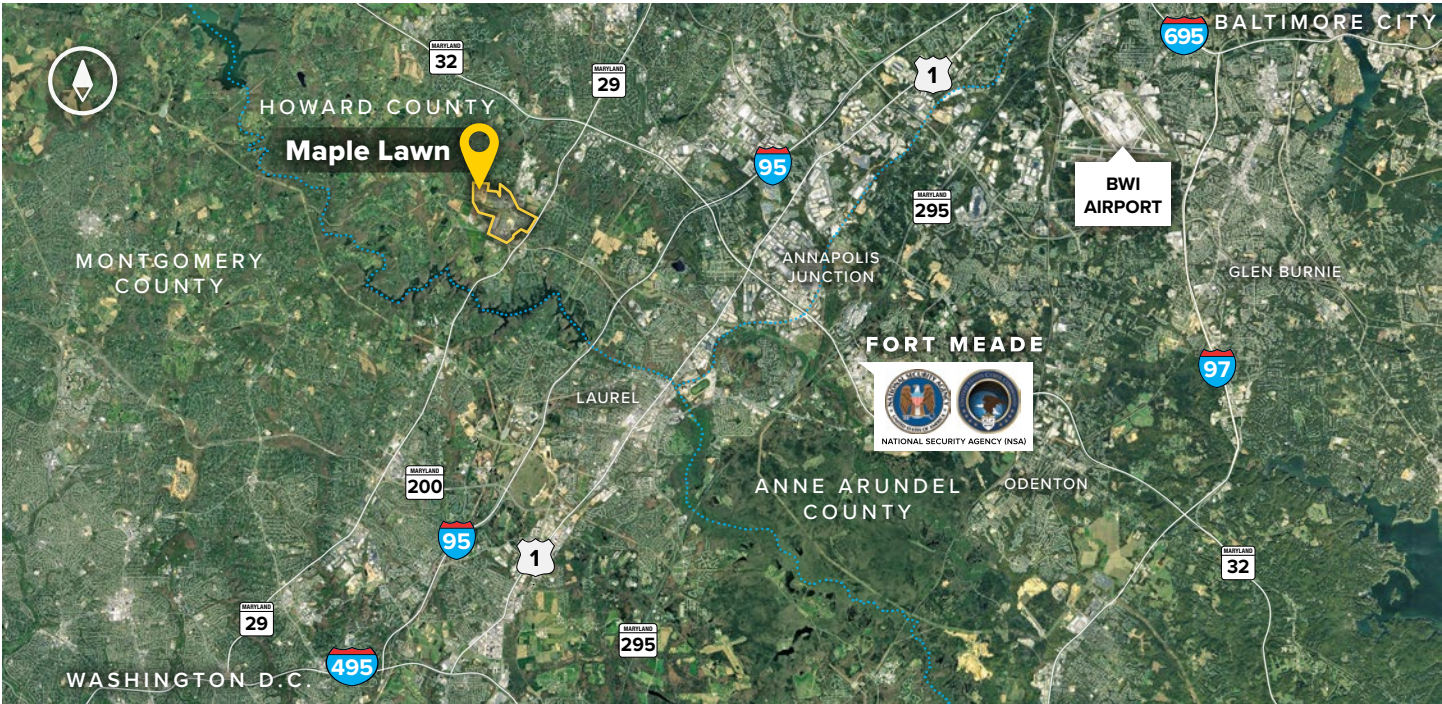

Distances to:

| | |
|---------------------------------------|-----------|
| AMTRAK | 20 miles |
| Annapolis (Downtown) | 31 miles |
| Baltimore (Downtown) | 22 miles |
| BWI Airport | 19 miles |
| Columbia (Downtown) | 6 miles |
| I-95 | 3 miles |
| I-495 (Capital Beltway) | 10 miles |
| I-695 (Baltimore Beltway) | 16 miles |
| Inter-County Connector (ICC) | 4.5 miles |
| JHU APL | 1 mile |
| MD Rt. 29 | 0.5 mile |
| MD-295 (Balt-Wash. Pkwy) | 8 miles |
| MD Rt. 32 | 2.7 miles |
| NIH | 25 miles |
| NSA and Ft. Meade | 9 miles |
| Reagan-National Airport | 32 miles |
| Washington-Dulles Intl. Airport | 44 miles |
| Washington, D.C. (Downtown) | 28 miles |

About St. John Properties

St. John Properties, Inc. is a full-service real estate company headquartered in Baltimore, Maryland. The company owns, manages and has developed more than 19 million square feet of commercial real estate, including office, flex/R&D, warehouse, retail and residential space.

For additional leasing information or to schedule a tour, contact:

Claire Cobert
Leasing Representative
 410.369.1274 | ccobert@sjpi.com

Richard Williamson
Senior VP, Leasing & Marketing
 410.369.1222 | rwilliamson@sjpi.com

Master Developer: **GREENEBAUM ENTERPRISES**



2560 Lord Baltimore Drive
 Baltimore, MD 21244
 410.788.0100 | SJPI.COM

CO | MD | NV | PA | LA | UT | VA | WI

Connect with us @stjohnprop



This information contained in this publication has been obtained from sources believed to be reliable. St. John Properties makes no guarantee, warranty or representation about this information. Any projections, opinions, assumptions or estimates used here are for example only and do not represent the current or future performance of the property. Interested parties should conduct an independent investigation to determine whether the property suits their needs. REV 10/18