

**MAPLE LAWN MULTI-STORY OFFICE**  
8115 Maple Lawn Boulevard | Fulton, MD 20759  
Suite 165 | First Floor

**TOTAL SF AVAILABLE:**  
2,193 SF

**KEY PLAN**  
NOT TO SCALE

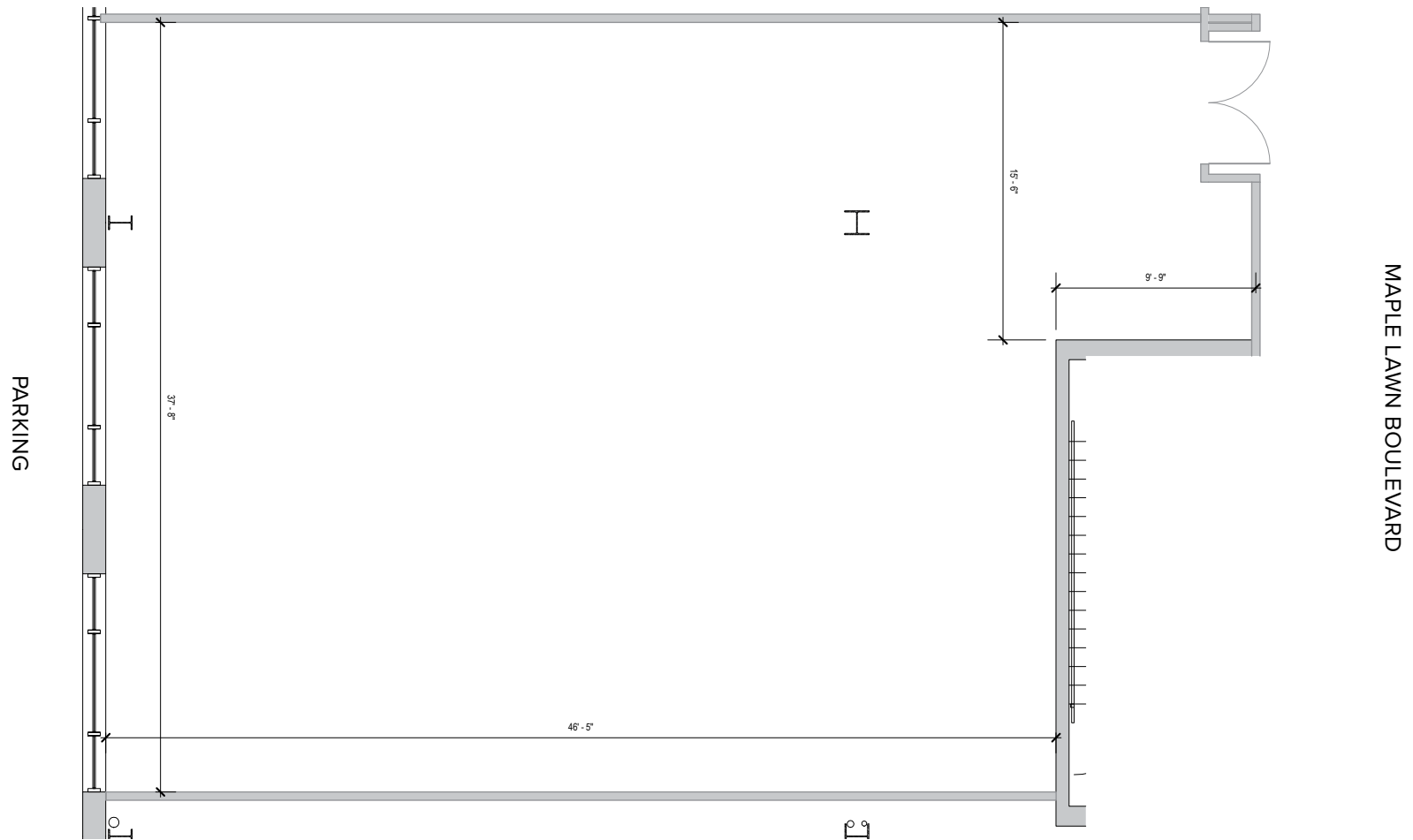
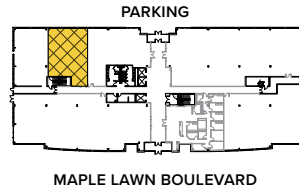

*Note: This space plan is subject to existing field conditions. This drawing is proprietary and the exclusive property of St. John Properties, inc. Any duplications, distribution, or other unauthorized use is strictly prohibited.*



## 8115 Maple Lawn Boulevard

Four-Story Class 'A' Office • 130,629 Sq. Ft.



8115 MAPLE LAWN BOULEVARD	
LEED	Gold   Core & shell
Suite Sizes	2,500 up to 130,629 SF
Office	Build to suit
Parking	4 spaces per 1,000 SF
Elevator	Yes
HVAC	Gas, VAV with zone control
Lease Type	Full Service

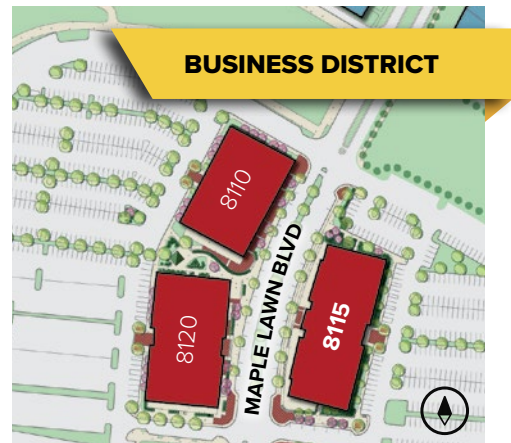



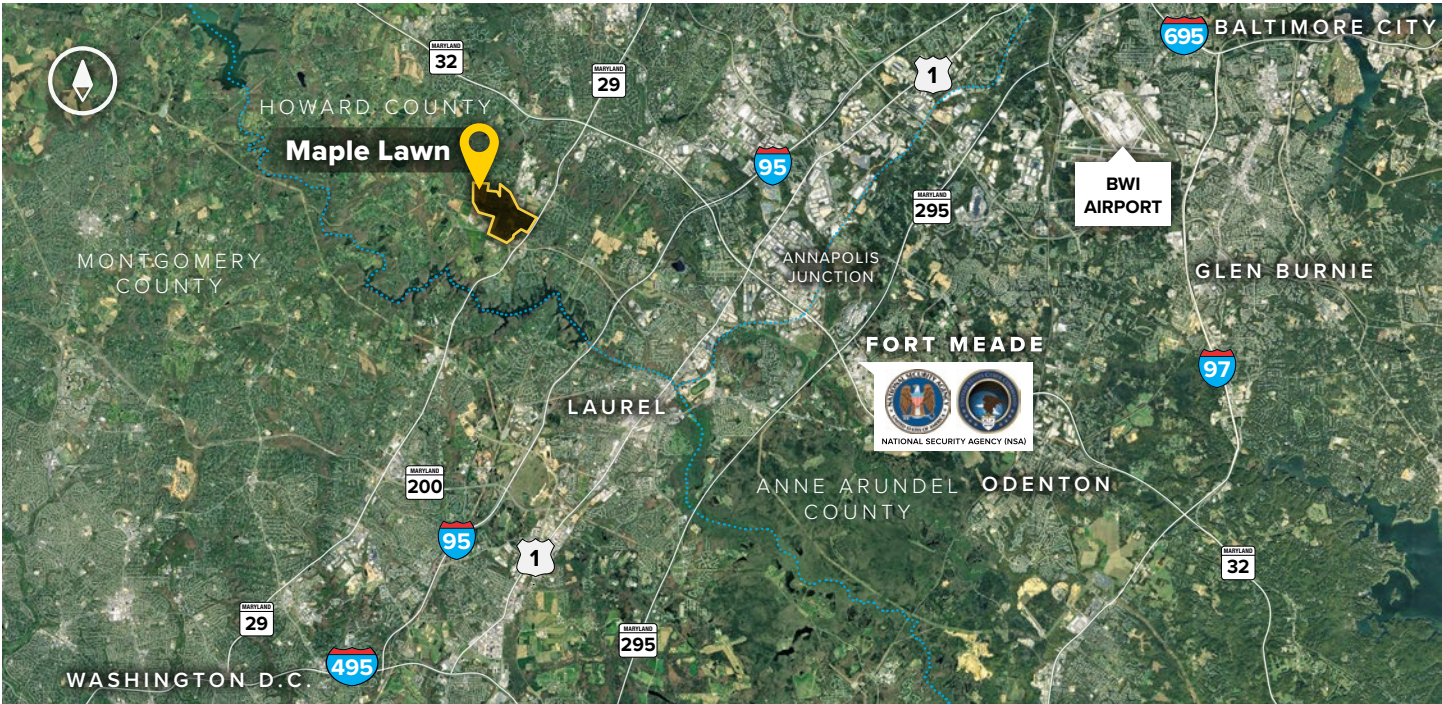

**Distances to:**

AMTRAK/Marc Station at BWI Airport .....	20 miles
Annapolis, MD (Downtown) .....	31 miles
Baltimore, MD (Downtown) .....	22 miles
BWI Airport .....	19 miles
Columbia, MD (Downtown) .....	6 miles
I-95 .....	3 miles
I-495 (Capital Beltway) .....	10 miles
I-695 (Baltimore Beltway) .....	16 miles
Intercounty Connector (ICC)/ MD 200 .....	4.5 miles
JHU APL .....	1 mile
MD Rt. 29 .....	0.5 mile
MD 295 (Balt-Wash. Pkwy) .....	8 miles
MD Rt. 32 .....	2.7 miles
NIH .....	25 miles
NSA and Ft. Meade .....	9 miles
Reagan-National Airport .....	32 miles
Washington-Dulles Intl. Airport .....	44 miles
Washington, D.C. (Downtown) .....	28 miles

**About St. John Properties**

St. John Properties, Inc. is a full-service real estate company headquartered in Baltimore, Maryland. The company owns, manages and has developed more than 19 million square feet of commercial real estate, including office, flex/R&D, warehouse, retail and residential space.

**For additional leasing information or to schedule a tour, contact:**

**Claire Cobert**  
*Leasing Representative*  
 410.369.1274 | ccobert@sjpi.com

**Sean Doordan**  
*Senior VP, Leasing & Acquisitions*  
 410.369.1211 | sdoordan@sjpi.com



Master Developer: **GREENEBAUM ENTERPRISES**



2560 Lord Baltimore Drive  
 Baltimore, MD 21244

**410.788.0100 | SJPI.COM**

MD | CO | LA | NV | PA | UT | VA | WI

Connect with us @stjohnprop



*This information contained in this publication has been obtained from sources believed to be reliable. St. John Properties makes no guarantee, warranty or representation about this information. Any projections, opinions, assumptions or estimates used here are for example only and do not represent the current or future performance of the property. Interested parties should conduct an independent investigation to determine whether the property suits their needs. REV 03/19*