

**TOTAL SF AVAILABLE:**  
2,760 SF

**KEY PLAN**  
NOT TO SCALE

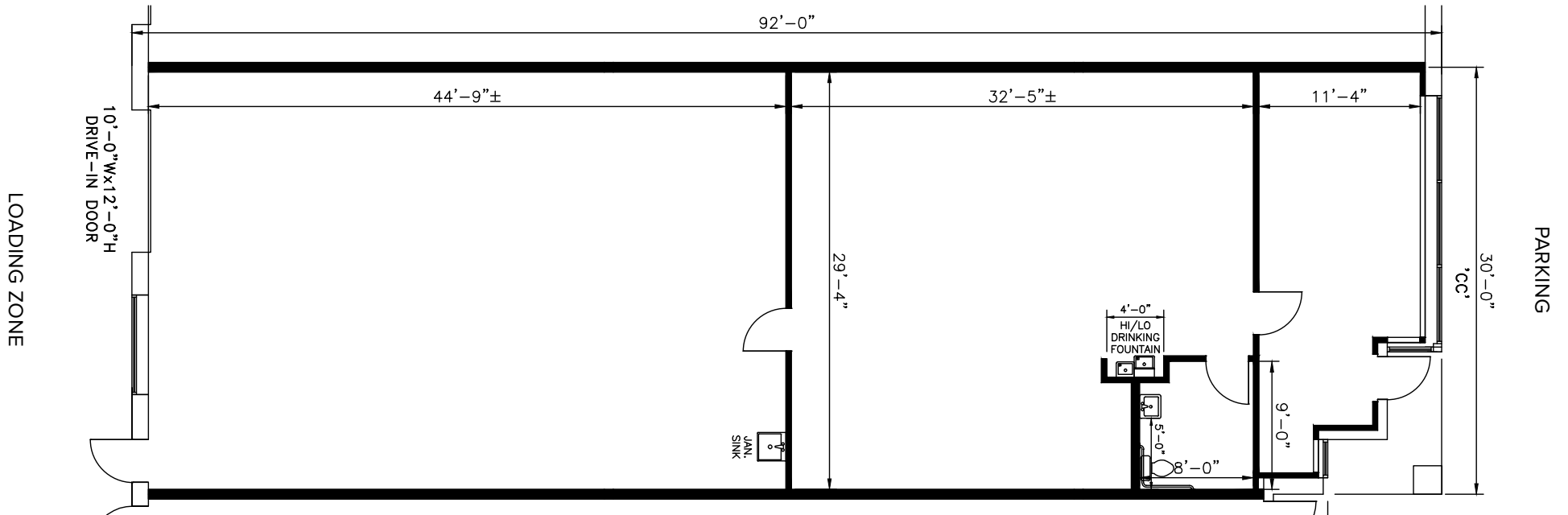
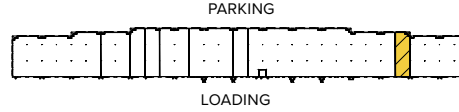

## About Riverside Tech Park

Riverside Tech Park is a 60-acre business community comprising of 12 buildings totaling 650,360 sq. ft. of space in an attractive and professional corporate environment. The park is ideally situated along the main entrance to the National Cancer Institutes's (NCI's) 330,000 sq. ft. state-of-the-art R&D facility, home to the Advanced Technology Partnerships Initiative (ATPI). NCI's facility is the nation's only federally funded R&D center dedicated solely to biomedical research and development. Additionally, Riverside provides exceptional access to local dining, shopping, and service amenities.

The buildings in Riverside Tech Park are high-utility, economical, and efficient, offering unmatched flexibility to provide a custom-tailored facility for our tenants' specific requirements, including office, laboratories, retail, and storage uses. The single-story buildings feature expansive 30 ft. by 30 ft. column spacing, 16 ft. clear heights, high voltage electric service, impressive drive-in and dock loading facilities, and flexibility for unlimited space configuration options.

For more information on  
Riverside Tech Park, visit:  
[sjpi.com/riversidetech](http://sjpi.com/riversidetech)



## Flex/R&D Space

### Flex/R&D Buildings

8415 Progress Drive	66,240 SF
8420 Gas House Pike	93,360 SF
8425 Precision Way	75,240 SF
8430 Spires Way	87,240 SF
8435 Progress Drive	84,240 SF
8445 Spires Way	81,240 SF
8400 Spires Way	16,200 SF
8411 Broadband Drive	32,560 SF
8421 Broadband Drive	40,120 SF
8431 Broadband Drive	35,840 SF
1750 Monocacy Boulevard	38,080 SF

### Flex/R&D Specifications

Suite Sizes	2,760 up to 93,360 SF
Ceiling Height	16 ft. clear minimum
Loading	Dock or drive-in
Roof	TPO & EPDM Rubber
Walls	Brick on block
Office	Build to suit
Parking	4 spaces per 1,000 SF
Heat	Gas
Zoning	MXE ( <i>employment &amp; retail</i> )



## Retail Tenants

### 1708 Monocacy Boulevard

Royal Farms	5,371 SF
-------------	----------





**Distances to:**

- BWI Airport ..... 50 miles
- Dulles International Airport ..... 44 miles
- Fort Detrick ..... 3 miles
- Frederick International Airport ..... 3 miles
- Interstate 70 ..... 2 miles
- Interstate 270 ..... 3 miles
- Route 15/340 ..... 2 miles
- Route 26 ..... 1 mile
- Washington, D.C. (Downtown) ..... 56 miles

**About St. John Properties**

St. John Properties, Inc. is a full-service real estate company that owns, manages and has developed more than 20 million square feet of commercial real estate, including office, flex/R&D, warehouse, retail and residential space.



5104 Pegasus Court | Suite A  
 Frederick, Maryland 20147  
**301.682.9215 | SJPI.COM**  
 MD | CO | LA | NV | PA | UT | VA | WI

Connect with us @stjohnprop    

**For additional leasing information  
 or to schedule a tour, contact:**

**Danny Foit**  
 Leasing Representative  
 301.682.9215 | dfoit@sjpi.com

**Matthew Holbrook**  
 Regional Partner,  
 Virginia & Central Maryland  
 301.682.9215 | mholbrook@sjpi.com



This information contained in this publication has been obtained from sources believed to be reliable. St. John Properties makes no guarantee, warranty or representation about this information. Any projections, opinions, assumptions or estimates used here are for example only and do not represent the current or future performance of the property. Interested parties should conduct an independent investigation to determine whether the property suits their needs. REV 09/19