

Total SF Available:
2,851 SF

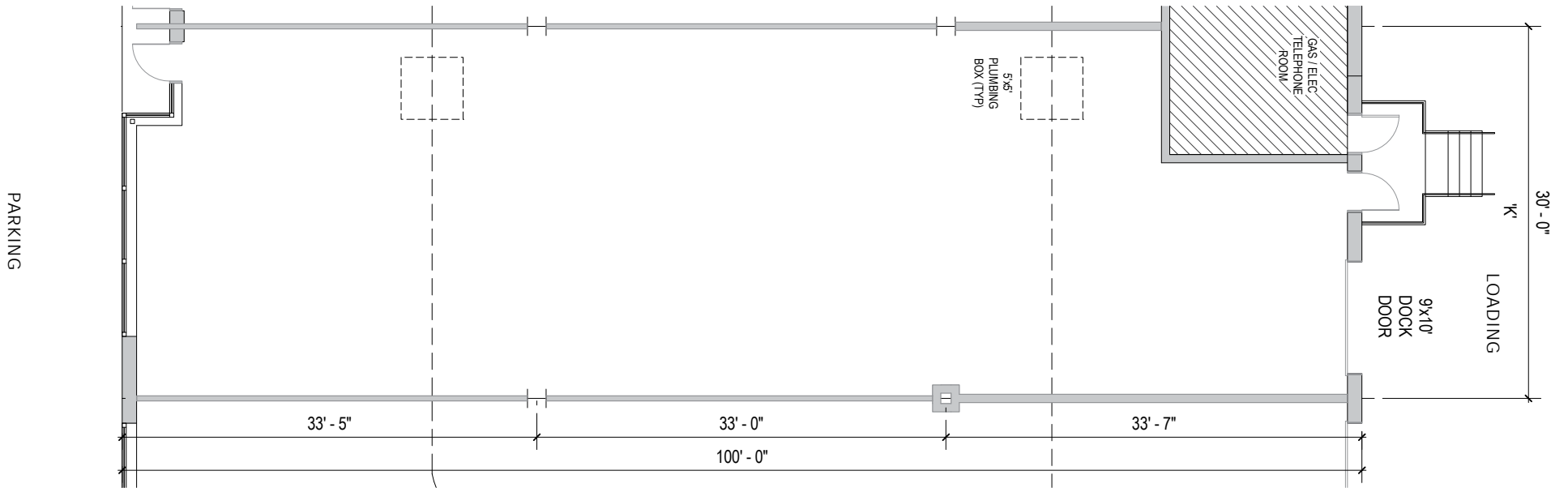

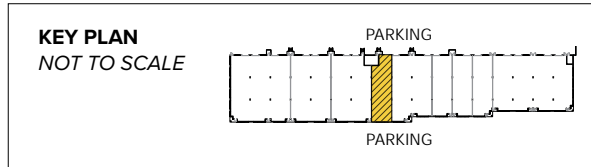
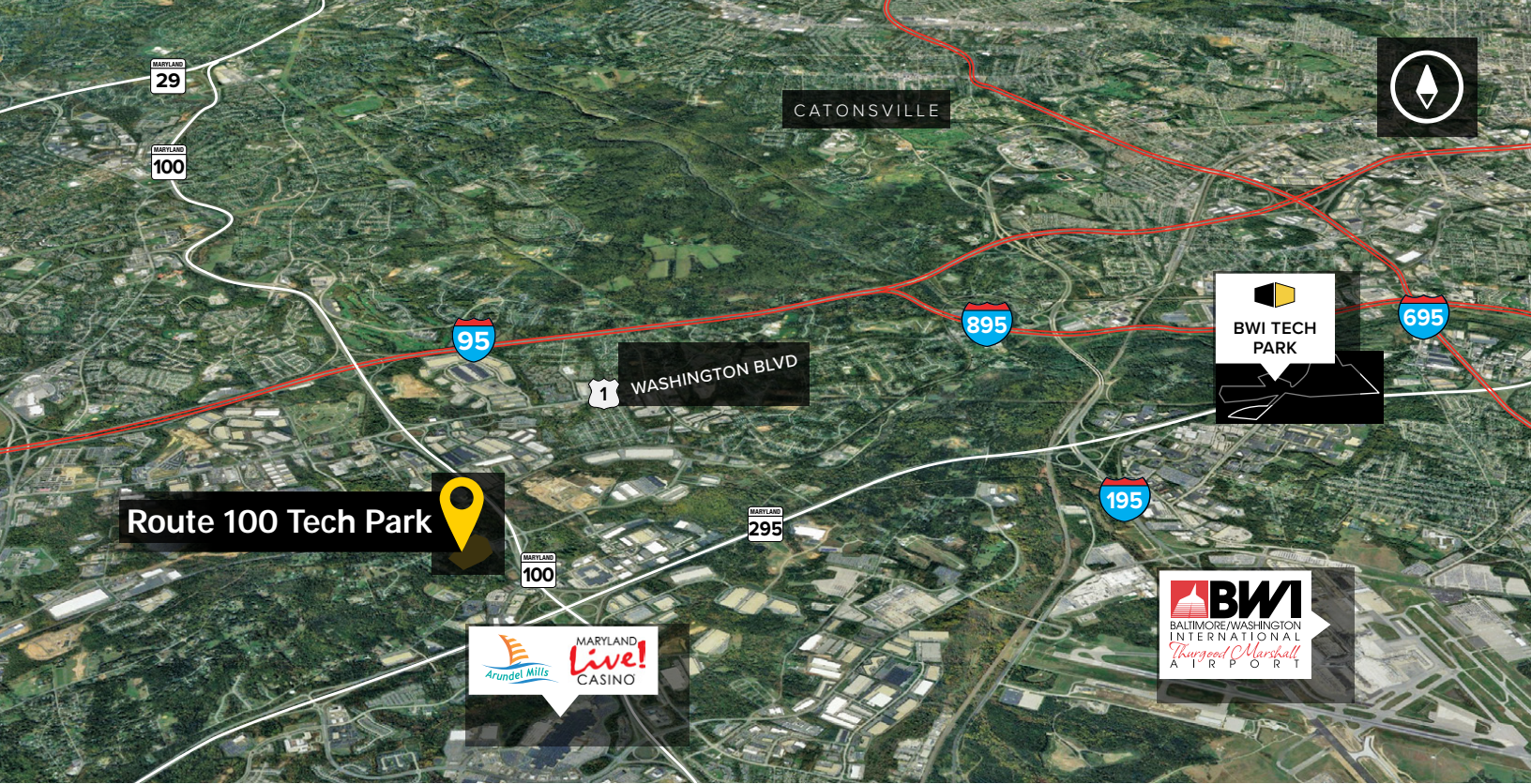

Distances to:

- Annapolis, MD (Downtown) 25 miles
- Arundel Mills Mall 2 miles
- Baltimore, MD (Downtown) 12 miles
- BWI Airport 5 miles
- Columbia, MD 10 miles
- Fort Meade/NSA 5 miles
- Interstate 95 2 miles
- Interstate 97 6 miles
- Interstate 695 (Baltimore Beltway) 6 miles
- MD 295 (Balto.-Wash. Pkwy) 0.5 miles
- Washington, D.C. (Downtown) 28 miles

For additional leasing information or to schedule a tour, contact:

Lacey Johansson
Leasing Representative
 410.369.1229 | ljohansson@sjpi.com

Sean Doordan
Senior VP, Leasing & Acquisitions
 410.369.1211 | sdoordan@sjpi.com

About St. John Properties

St. John Properties, Inc. is a full-service real estate company headquartered in Baltimore, Maryland. The company owns, manages and has developed more than 20 million square feet of commercial real estate, including office, flex/R&D, warehouse, retail and residential space.



2560 Lord Baltimore Drive
 Baltimore, MD 21244

410.788.0100 | SJPI.COM

MD | CO | LA | NV | PA | UT | VA | WI

Connect with us [@stjohnprop](https://www.instagram.com/stjohnprop)



This information contained in this publication has been obtained from sources believed to be reliable. St. John Properties makes no guarantee, warranty or representation about this information. Any projections, opinions, assumptions or estimates used here are for example only and do not represent the current or future performance of the property. Interested parties should conduct an independent investigation to determine whether the property suits their needs. REV 07/20