

**Total SF Available:**  
1,300 SF

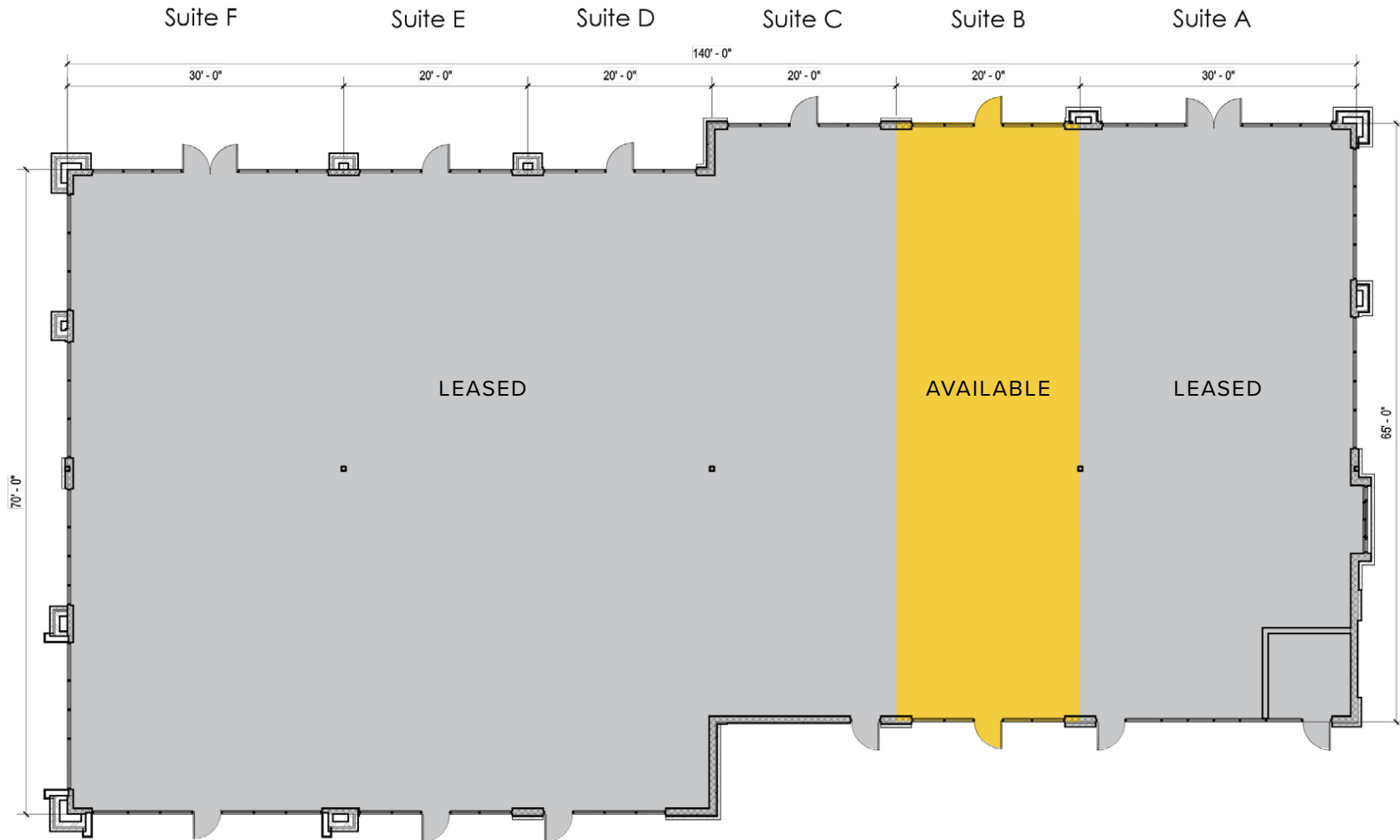



## Inline Retail | Suites available up to 11,250 Sq. Ft.



### Inline Retail

Retail Buildings		
1043 S Valley Grove Way	9,725 SF	
1051 S Valley Grove Way	9,377 SF	
1865 W Pleasant Grove Blvd	11,250 SF	
1882 W Pleasant Grove Blvd	10,361 SF	
1926 W Pleasant Grove Blvd	10,467 SF	
Retail A	7,800 SF	FUTURE
Retail B	7,800 SF	FUTURE
Retail H	10,000 SF	FUTURE
Retail J	10,500 SF	FUTURE

### Demographics

	1 Mile	3 Miles	5 Miles
Population	7,264	61,126	153,817
Avg. Household Income	\$79,953	\$98,766	\$103,753

### Traffic Counts

North County Blvd (W 700 N): 35,000 vehicles/day
Pleasant Grove Blvd: 60,000 vehicles/day

*Join Wok The Line, The Village Baker, Starbucks, Jersey Mike's Subs, Gloss Salon, Belle Medical, Verizon Wireless, and more!*





**Distances to:**

- Interstate 215 ..... 25 miles
- Provo, UT ..... 12 miles
- Salt Lake City, UT ..... 34.5 miles
- Salt Lake City International Airport ..... 38 miles

**About St. John Properties**

St. John Properties, Inc. is a full-service real estate company headquartered in Baltimore, Maryland. The company owns, manages and has developed more than 20 million square feet of commercial real estate, including office, flex/R&D, warehouse, retail and residential space.

**For additional leasing information or to schedule a tour, contact:**

**Scott Gifford**  
*Leasing Representative*  
 sgifford@sjpiutah.com  
 801.899.7991

**Daniel Thomas**  
*Regional Partner, Utah*  
 dthomas@sjpiutah.com  
 801.899.7991



1982 W Pleasant Grove Boulevard | Suite D  
 Pleasant Grove, Utah 84062

**801.899.7991 | THEVALLEYGROVE.COM**  
 MD | CO | LA | NV | PA | UT | VA | WI

Connect with us @thevalleygrove  



This information contained in this publication has been obtained from sources believed to be reliable. St. John Properties makes no guarantee, warranty or representation about this information. Any projections, opinions, assumptions or estimates used here are for example only and do not represent the current or future performance of the property. Interested parties should conduct an independent investigation to determine whether the property suits their needs. REV 05/20