

VALLEY GROVE

1865 W. Pleasant Grove Boulevard | Pleasant Grove, UT 84062
Suite D

TOTAL SF AVAILABLE:
1,394 SF

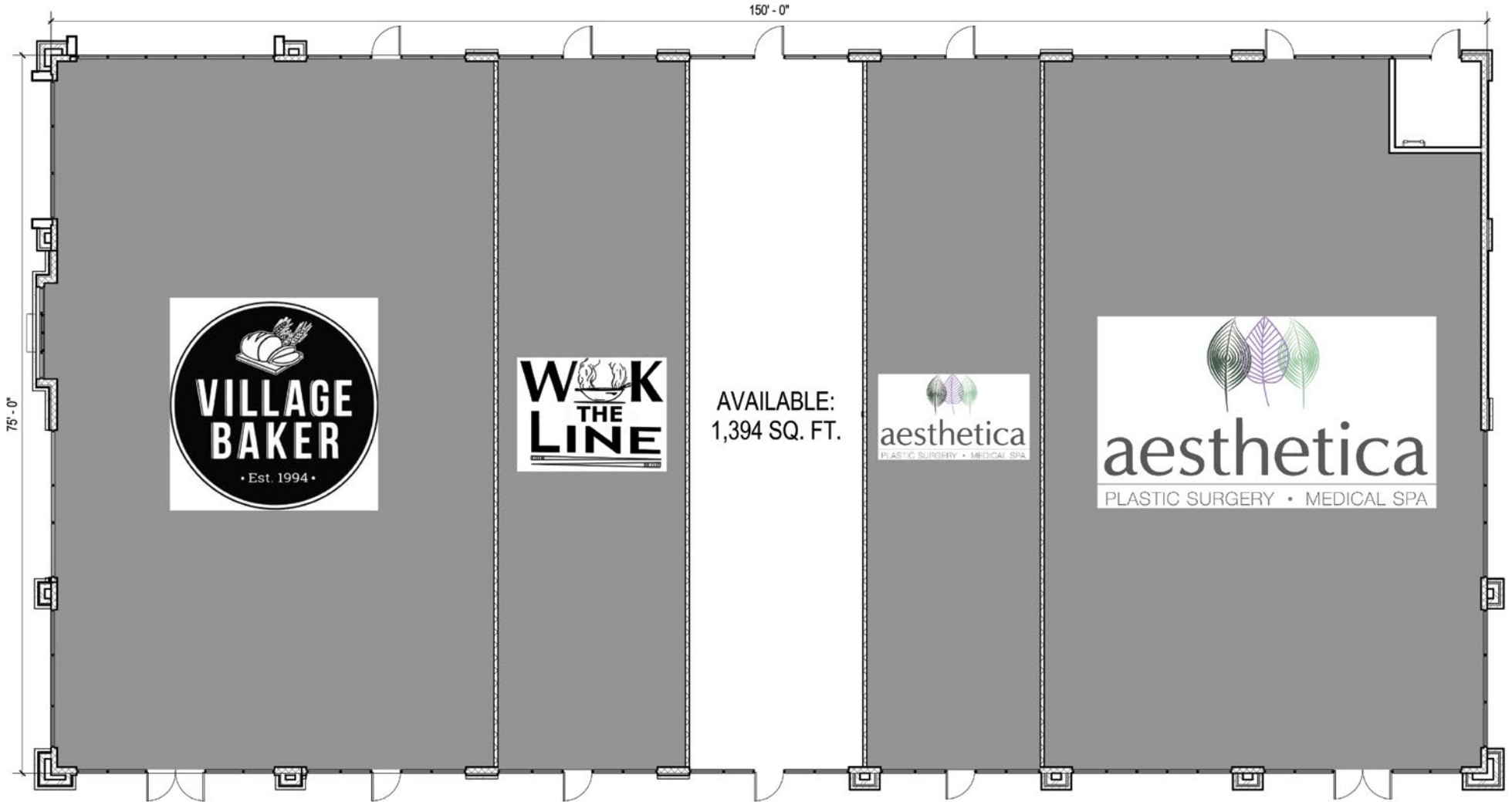

Note: This space plan is subject to existing field conditions. This drawing is proprietary and the exclusive property of St. John Properties, inc. Any duplications, distribution, or other unauthorized use is strictly prohibited.

Inline retail spaces offering drive-thru and patio seating



Inline Retail

Suites available up to 11,250 Sq. Ft. | Offering drive-thrus and patio seating



INLINE RETAIL

RETAIL BUILDINGS

1865 W Pleasant Grove Blvd	11,250 SF	
1882 W Pleasant Grove Blvd	10,361 SF	
1962 W Pleasant Grove Blvd	10,467 SF	
Retail A	7,800 SF	FUTURE
Retail B	7,800 SF	FUTURE
Retail F	7,800 SF	FUTURE
Retail G	10,000 SF	FUTURE
Retail H	10,500 SF	FUTURE

DEMOGRAPHICS

	1 Mile	3 Miles	5 Miles
Population	7,264	61,126	153,817
Avg. Household Income	\$79,953	\$98,766	\$103,753

TRAFFIC COUNT

Pleasant Grove Blvd at W 700 N - 23,400 vehicles/day



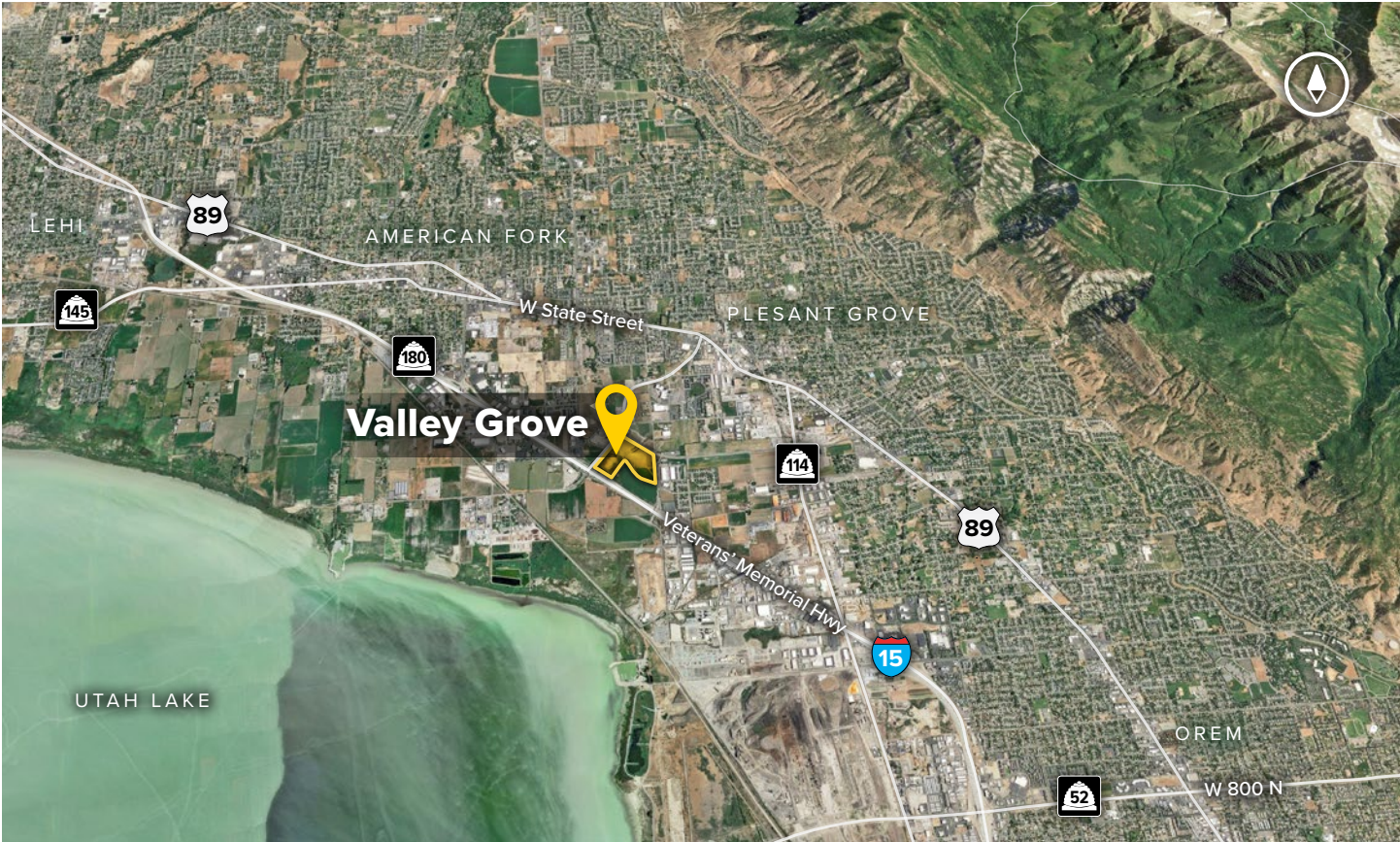

Distances to:

- I-215 25 miles
- Provo, UT 12 miles
- Salt Lake City, UT 34.5 miles
- Salt Lake City International Airport 38 miles

About St. John Properties

St. John Properties, Inc. is a full-service real estate company headquartered in Baltimore, Maryland. The company owns, manages and has developed more than 19 million square feet of commercial real estate, including office, flex/R&D, warehouse, retail and residential space.

**For additional leasing information
or to schedule a tour, contact:**

Daniel Thomas
Regional Partner, Utah
801.899.7991 | dthomas@sjpiutah.com



1982 W Pleasant Grove Boulevard | Suite D
Pleasant Grove, Utah 84062

801.899.7991 | THEVALLEYGROVE.COM
MD | CO | LA | NV | PA | UT | VA | WI



Connect with us @thevalleygrove



This information contained in this publication has been obtained from sources believed to be reliable. St. John Properties makes no guarantee, warranty or representation about this information. Any projections, opinions, assumptions or estimates used here are for example only and do not represent the current or future performance of the property. Interested parties should conduct an independent investigation to determine whether the property suits their needs. REV 01/19