

VALLEY GROVE

1953 W. Pleasant Grove Boulevard | Pleasant Grove, UT 84062
Suites B-F

TOTAL SF AVAILABLE:

Up to 4,287 SF

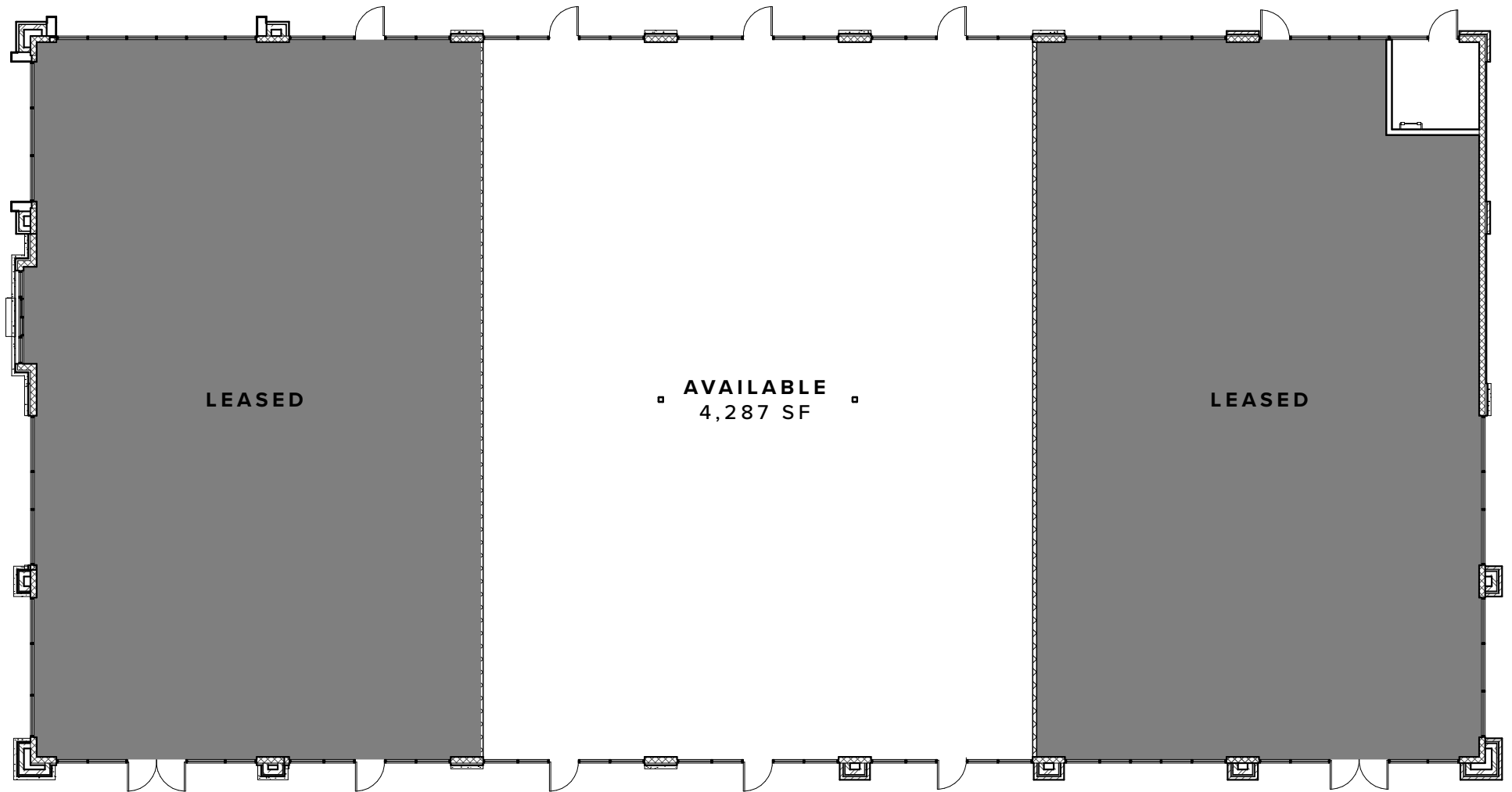



RETAIL SPACE

RETAIL SPACE

RETAIL A & B	15,600 SF	Patio Seating
RETAIL C & D	22,500 SF	Drive-Thru
RETAIL E	10,500 SF	Drive-Thru & Patio
RETAIL F	10,500 SF	Drive-Thru & Patio
RETAIL G	10,000 SF	Drive-Thru & Patio



PAD SITES

PAD SITES

Pad 1	1.44 ACRES	Pad 6	.92 ACRES
Pad 2	1.135 ACRES	Pad 7	.90 ACRES
Pad 3	.916 ACRES	Pad 8	.77 ACRES
Pad 4	1.00 ACRES	Pad 9	1.00 ACRES
Pad 5	1.00 ACRES		



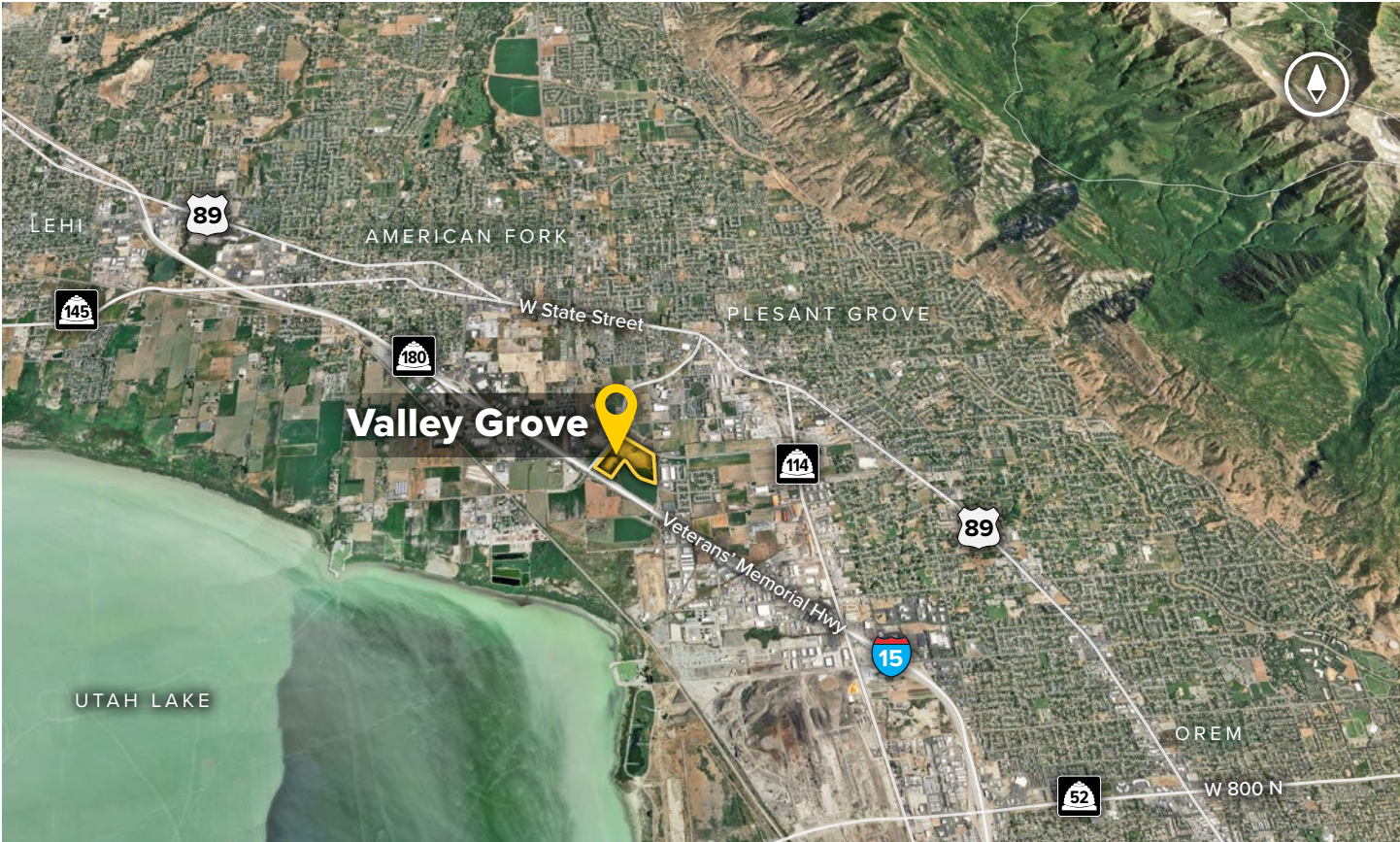

Distances to:

- I-1525 mile
- I-215 25 miles
- Provo, UT 12 miles
- Salt Lake City, UT 34.5 miles
- Salt Lake City International Airport 38 miles

**For additional leasing information
or to schedule a tour, contact:**

Daniel Thomas *Regional Partner*
801.899.7991 | dthomas@sjiutah.com

About St. John Properties

St. John Properties, Inc. is a full-service real estate company headquartered in Baltimore, Maryland. The company owns, manages and has developed more than 19 million square feet of commercial real estate, including office, flex/R&D, warehouse, retail and residential space.



1982 W. Pleasant Grove Boulevard, Suite D
Pleasant Grove, Utah 84062
801.899.7991 | THEVALLEYGROVE.COM
MD | CO | LA | NV | PA | UT | VA | WI



Connect with us @thevalleygrove  

This information contained in this publication has been obtained from sources believed to be reliable. St. John Properties makes no guarantee, warranty or representation about this information. Any projections, opinions, assumptions or estimates used here are for example only and do not represent the current or future performance of the property. Interested parties should conduct an independent investigation to determine whether the property suits their needs. REV 10/18