

**Valley Grove**

2100 W. Pleasant Grove Boulevard | Pleasant Grove, UT 84062

Suite 230 | Second Floor



**Total SF Available:**

732 SF

*LEED Certified Class 'A' office;  
second floor office space with  
existing build-out*

**KEY PLAN**  
NOT TO SCALE



*Note: This space plan is subject to existing field conditions. This drawing is proprietary and the exclusive property of St. John Properties, Inc. Any duplications, distribution, or other unauthorized use is strictly prohibited.*

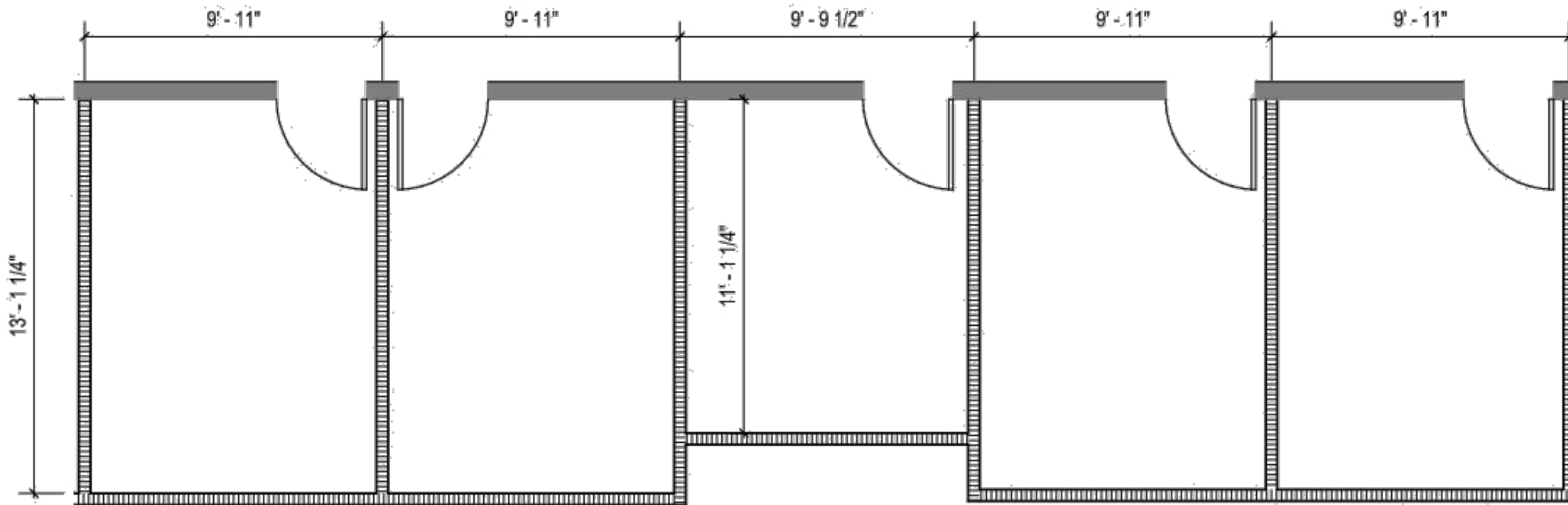



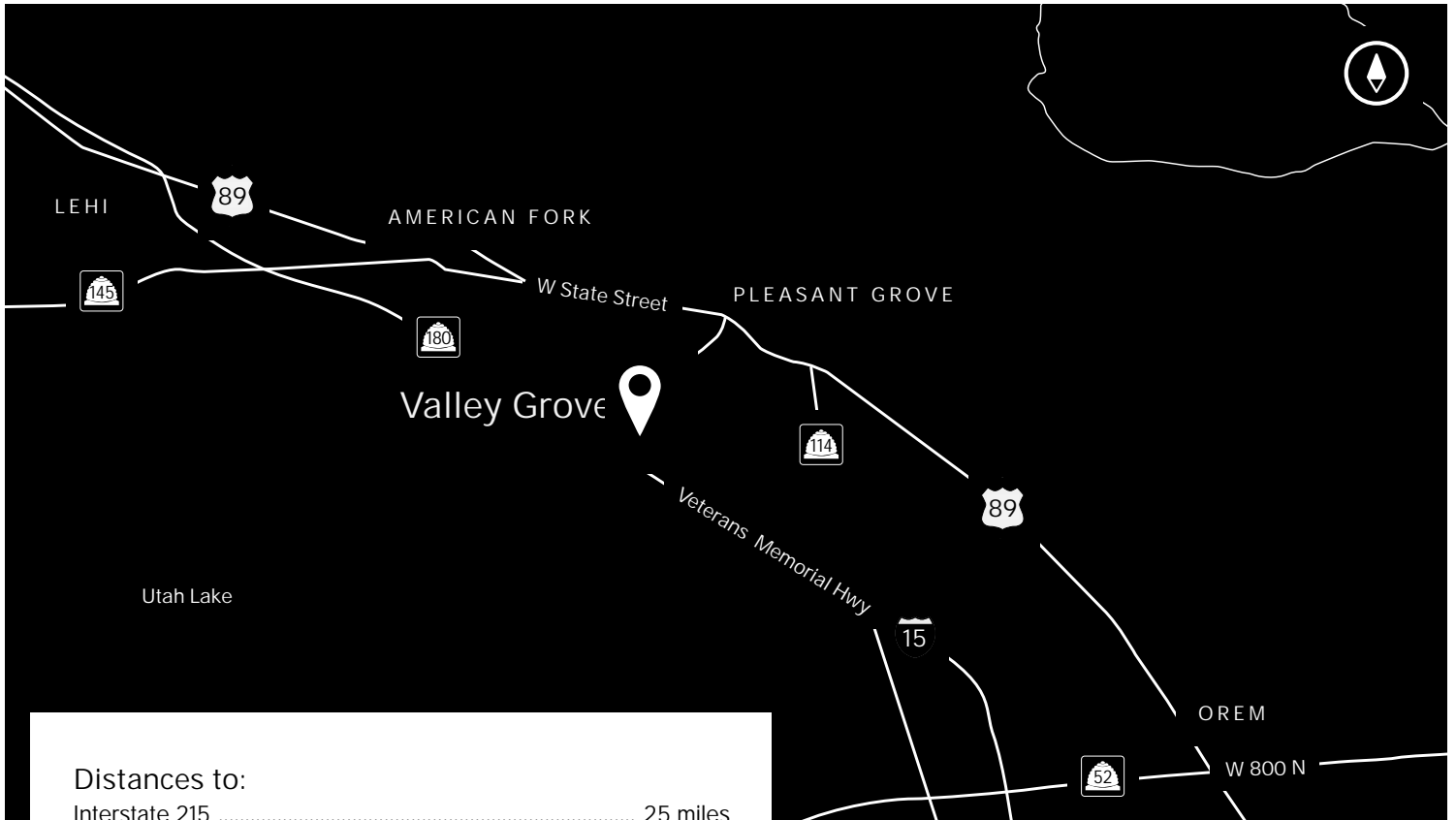

Distances to:

Interstate 215 .....	25 miles
Provo, UT .....	12 miles
Salt Lake City, UT .....	34.5 miles
Salt Lake City International Airport .....	38 miles



Scan with your mobile device to take a virtual tour, download floor plans and more!

# Contact Us

For additional leasing information or to schedule a tour, contact:

Scott Giord Leasing Representative sggiord@sjpiutah.com 801.899.7991	Daniel Thomas Regional Partner, Utah dthomas@sjpiutah.com 801.899.7991
---	---

Utah Office:  
1064 S. North County Boulevard | Suite 190  
Pleasant Grove, Utah 84062

801.899.7991 | THEVALLEYGROVE.COM

**About St. John Properties**  
St. John Properties, Inc. is a full-service real estate company headquartered in Baltimore, Maryland. The company owns, manages and has developed more than 21 million square feet of commercial real estate, including office, ex/R&D, warehouse, retail and residential space.

Connect with us @stjohnprop



This information contained in this publication has been obtained from sources believed to be reliable. St. John Properties makes no guarantee, warranty or representation about this information. Any projections, opinions, assumptions or estimates used here are for example only and do not represent the current or future performance of the property. Interested parties should conduct an independent investigation to determine whether the property suits their needs. REV 10/21