

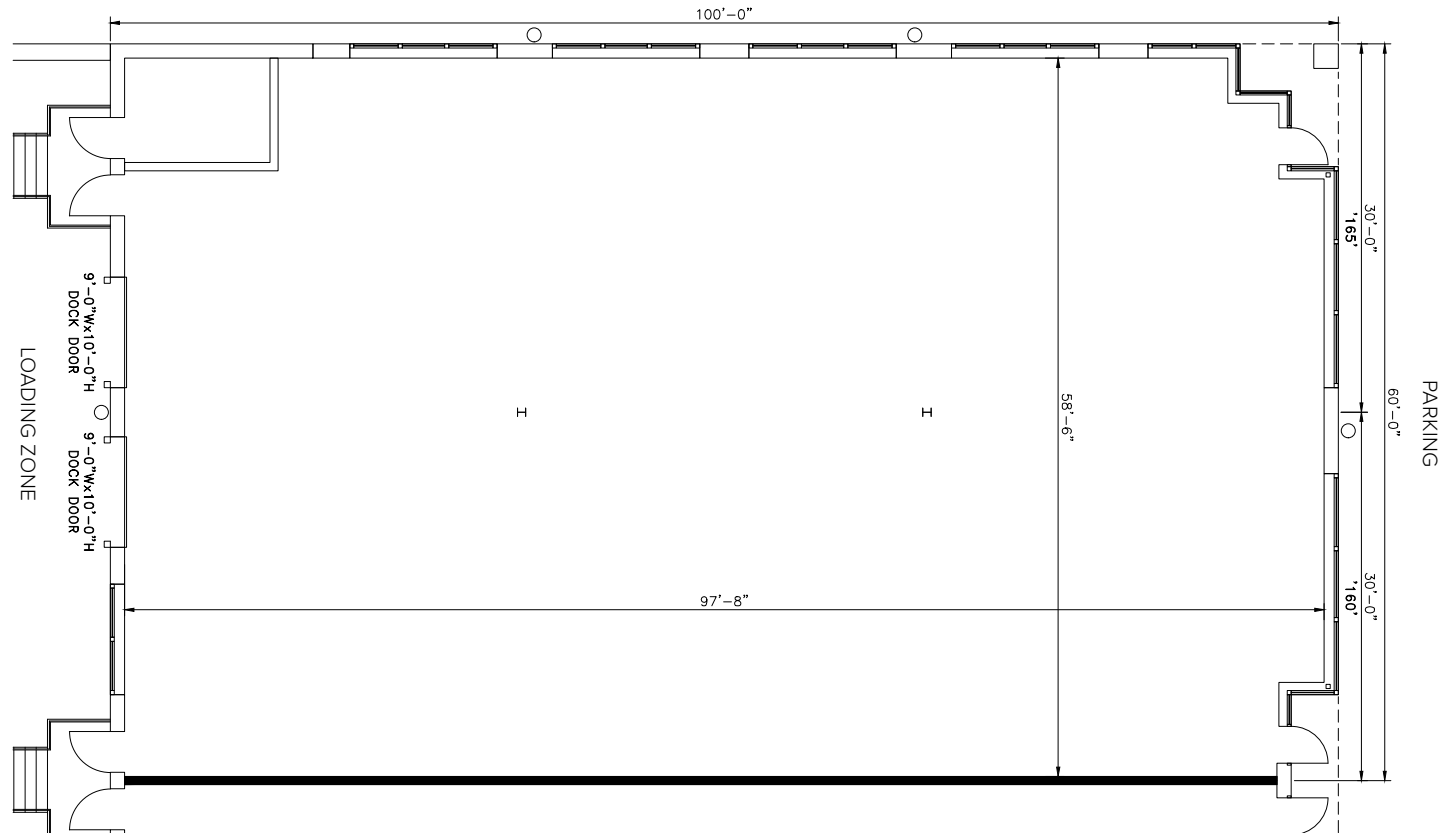

**Total SF Available:**  
3,000–6,000 SF

*New LEED designed flex/R&D  
shell space with (2) 9 x10 rear  
dock doors*



**Note:** This space plan is subject to existing field conditions. This drawing is proprietary and the exclusive property of St. John Properties, Inc. Any duplications, distribution, or other unauthorized use is strictly prohibited.



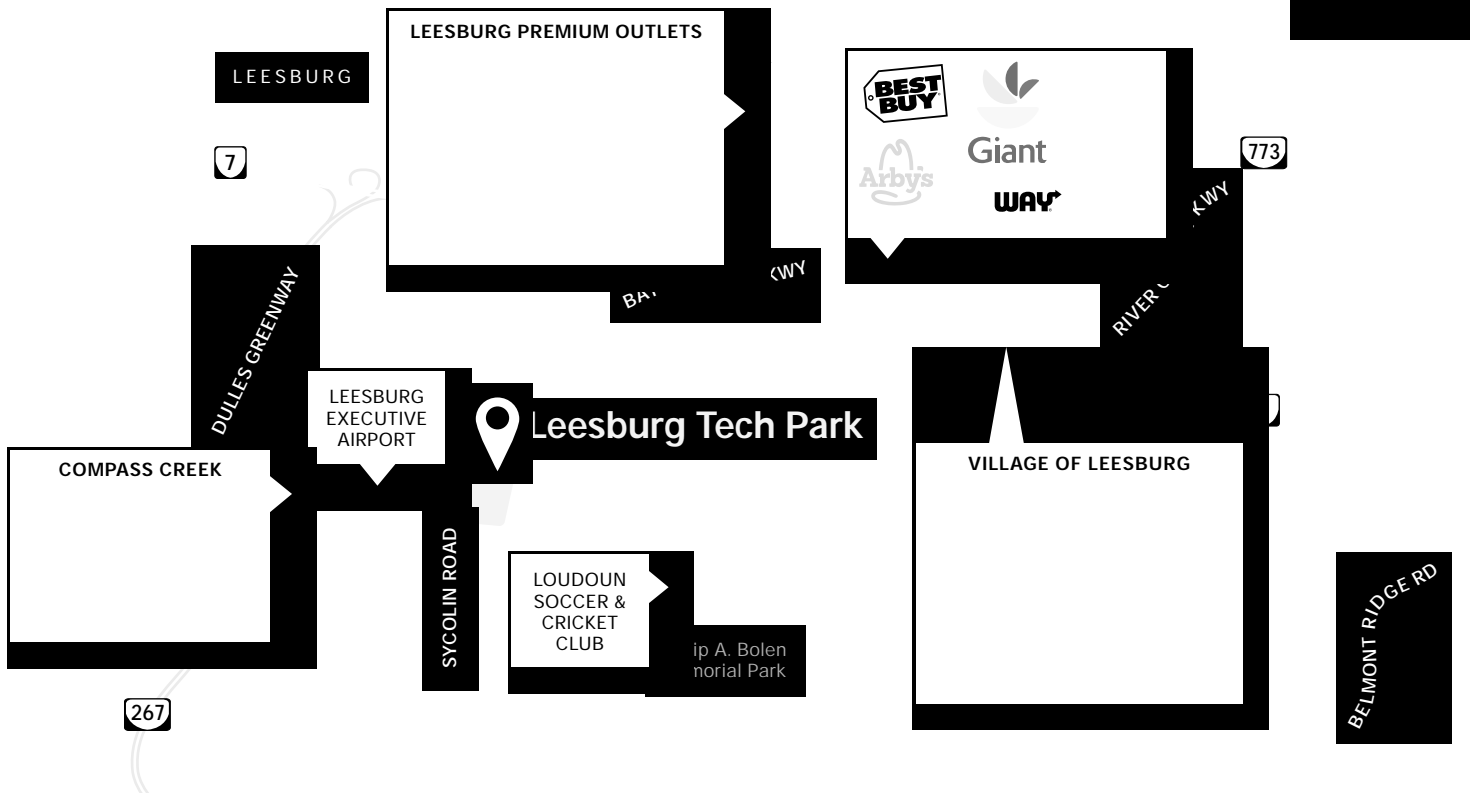

TO ASHBURN

**Distances to:**

- Ashburn, VA ..... 5 miles
- Dulles International Airport ..... 13 miles
- Leesburg Executive Airport ..... 0.1 miles
- Reston, VA ..... 9 miles
- Tysons Corner ..... 16 miles
- VA Route 7 (Harry Byrd Highway) ..... 2 miles
- VA Route 28 (Nokes Boulevard) ..... 8 miles
- VA Route 267 (Dulles Greenway) ..... 1.5 miles
- Washington, D.C. .... 35 miles

# Contact Us

For additional leasing information or to schedule a tour, contact:

**Danny Foit**  
 Leasing Representative  
 dfoit@sjpi.com  
 703.858.9215

**Matt Holbrook**  
 Regional Partner, Virginia &  
 Central Maryland  
 mholbrook@sjpi.com  
 703.858.9215

Virginia Regional Office:  
 21750 Red Rum Drive | Suite 182  
 Ashburn, Virginia 20147

703.858.9215 | SJPI.COM/VIRGINIA



Scan with your mobile device to take a virtual tour, download our plans and more!

**About St. John Properties**

St. John Properties, Inc. is a full-service real estate company headquartered in Baltimore, Maryland. The company owns, manages and has developed more than 21 million square feet of commercial real estate, including office, ex/R&D, warehouse, retail and residential space.

Connect with us @stjohnprop



*This information contained in this publication has been obtained from sources believed to be reliable. St. John Properties makes no guarantee, warranty or representation about this information. Any projections, opinions, assumptions or estimates used here are for example only and do not represent the current or future performance of the property. Interested parties should conduct an independent investigation to determine whether the property suits their needs. REV 04/21*