

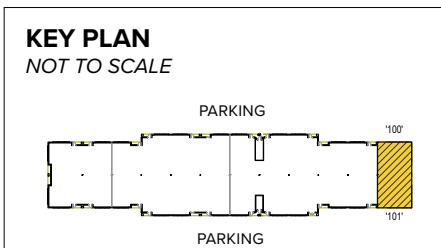

**TOTAL SF AVAILABLE:**  
2,345 SF

*All office, end unit*



**Note:** This space plan is subject to existing field conditions. This drawing is proprietary and the exclusive property of St. John Properties, inc. Any duplications, distribution, or other unauthorized use is strictly prohibited.

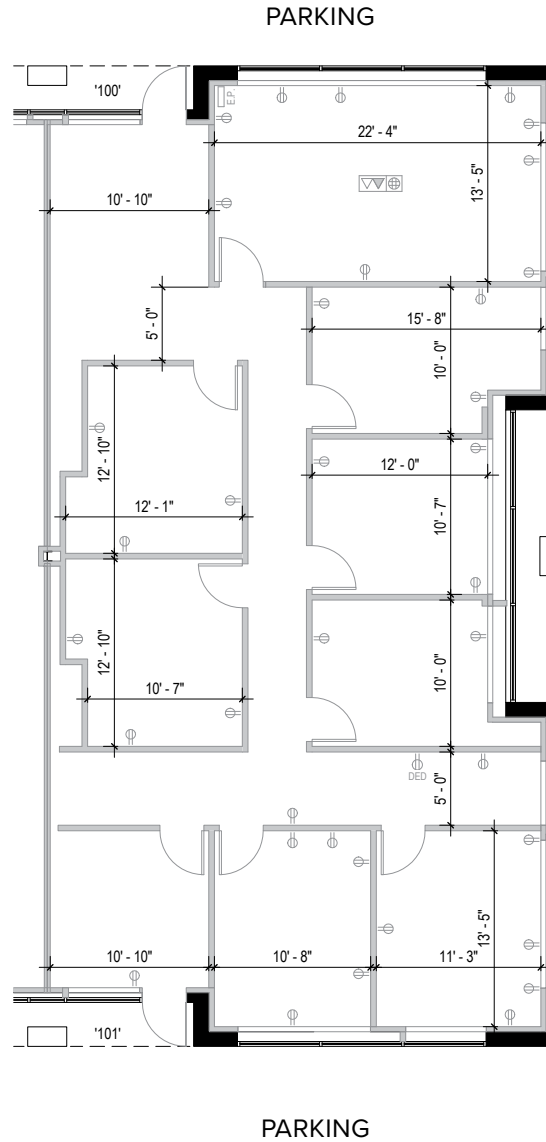





**Distances to:**

Annapolis, MD (Downtown) .....	22 miles
Arundel Mills Mall .....	4 miles
Baltimore, MD (Downtown) .....	8 miles
BWI Airport .....	2 miles
Columbia, MD.....	12 miles
Interstate 495 (Capital Beltway) .....	19 miles
Interstate 695 (Baltimore Beltway) .....	3 miles
MD 100 .....	4 miles
MD 295 .....	0.1 mile

# Contact Us

For additional leasing information or to schedule a tour, contact:

**OFFICE & FLEX/R&D SPACE:**

**Lacey Johansson**

Leasing Representative

ljohansson@sjpi.com

410.369.1229

**Matt Lenihan**

Vice President, Leasing

mleihan@sjpi.com

410.369.1202

**RETAIL SPACE:**

**Eric Llewellyn**

Retail Leasing Representative

ellewellyn@sjpi.com

443.369.1308

**Bill Holzman**

Vice President, Retail Leasing

bholzman@sjpi.com

410.369.1240

**About St. John Properties**

St. John Properties, Inc. is a full-service real estate company headquartered in Baltimore, Maryland. The company owns, manages and has developed more than 21 million square feet of commercial real estate, including office, flex/R&D, warehouse, retail and residential space.

Connect with us @stjohnprop

**NAIOP** MARYLAND CHAPTER  
COMMERCIAL REAL ESTATE DEVELOPMENT ASSOCIATION  
THE ASSOCIATION FOR COMMERCIAL REAL ESTATE

**NAIOP** NATIONAL DEVELOPER OF THE YEAR — 2018

**Corporate Headquarters:**  
2560 Lord Baltimore Drive,  
Baltimore, MD 21244

**410.788.0100 | SJPI.COM**

*This information contained in this publication has been obtained from sources believed to be reliable. St. John Properties makes no guarantee, warranty or representation about this information. Any projections, opinions, assumptions or estimates used here are for example only and do not represent the current or future performance of the property. Interested parties should conduct an independent investigation to determine whether the property suits their needs. REV 03/21*