

TOTAL SF AVAILABLE:
2,252 - 30,850 SF

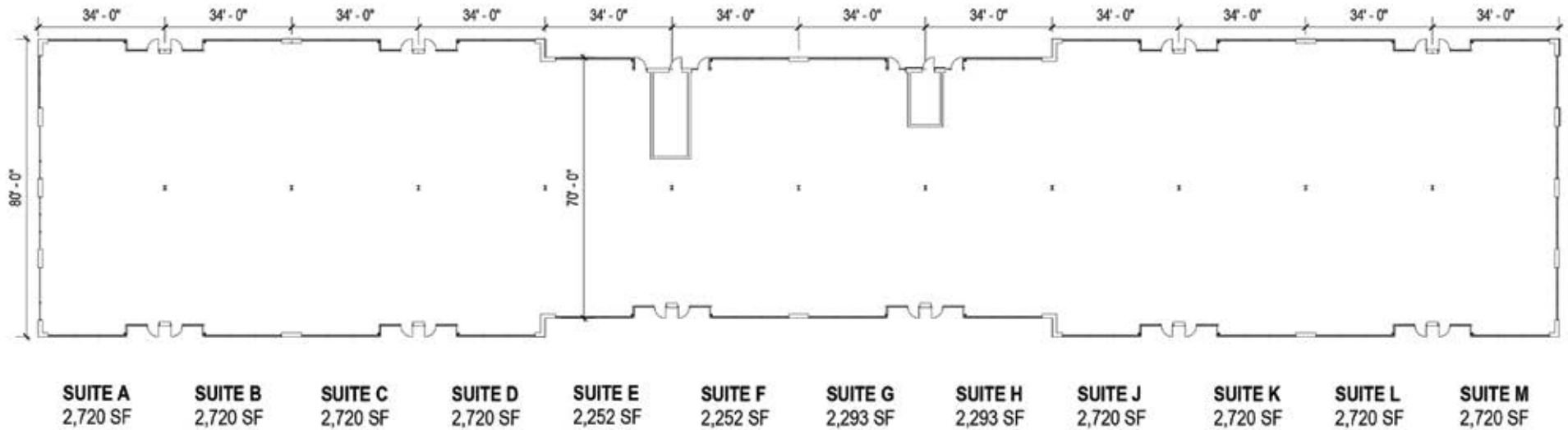

About Beltway West

Beltway West is a 19-acre business community located at Interstate 215 and 2700 West (Constitution Boulevard) in Salt Lake County, Utah just minutes from downtown Salt Lake City and Salt Lake International Airport.

The unified architecture of St. John Properties' five buildings, comprising over 273,000 square feet of office space, provides Beltway West a campus-like business environment. Tenant sizes are available up to 154,190 square feet of space and offer businesses straight-forward, economical and high-utility space in a covenant-protected, well-maintained atmosphere.

For more information on
Beltway West, visit:
sjpi.com/beltwaywestutah



Single-Story Office

Single-Story Office Buildings

Building A	30,850 SF
Building B	30,850 SF
Building C	28,560 SF
Building D	28,560 SF

Single-Story Office Specifications

LEED	Designed
Suite Sizes	Up to 30,850 SF
Ceiling Height	10-14 ft. clear minimum
Offices	Built to suit
Parking	5 per 1,000 SF

Multi-Story Office

Six-Story Office Building

Building E	154,190 SF
------------	------------

Six-Story Office Specifications

LEED	Designed
Suite Sizes	Up to 154,190 SF
Ceiling Height	10-13 ft. clear minimum
Offices	Built to suit
Parking	5 per 1,000 SF



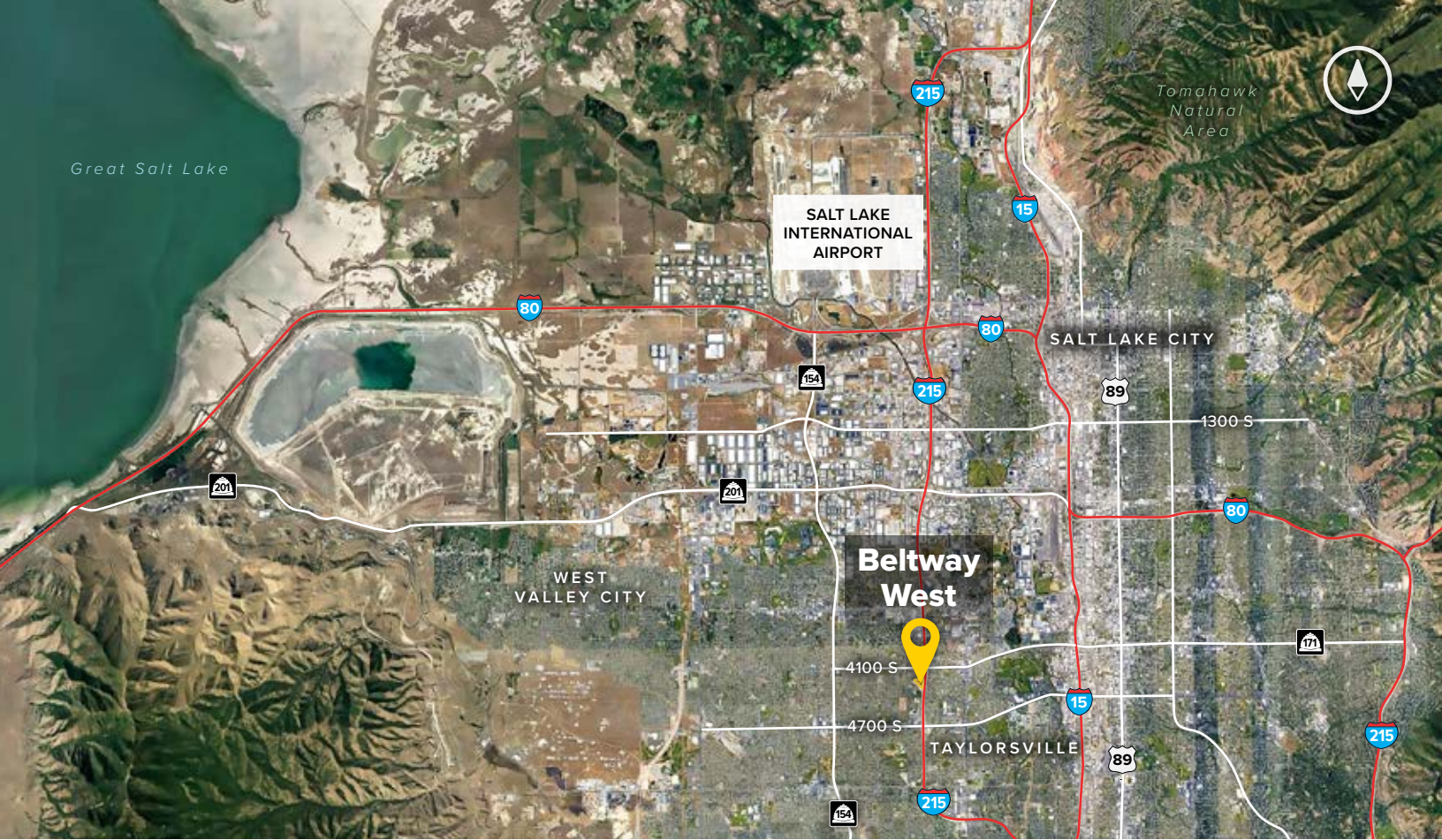

Distances to:

- American Fork, UT 27 miles
- Interstate 15 3.8 miles
- Interstate 215 1.7 miles
- Provo, UT (Downtown) 40 miles
- Salt Lake City, UT (Downtown) 9 miles
- Salt Lake City International Airport 9 miles
- Spanish Fork, UT 48 miles

About St. John Properties

St. John Properties, Inc. is a full-service real estate company headquartered in Baltimore, Maryland. The company owns, manages and has developed more than 20 million square feet of commercial real estate, including office, flex/R&D, warehouse, retail and residential space.



1982 W Pleasant Grove Boulevard | Suite D
Pleasant Grove, UT 84062

801.899.7991 | SJPI.COM/UTAH

MD | CO | LA | NV | PA | UT | VA | WI

**For additional leasing information
or to schedule a tour, contact:**

Scott Gifford

Leasing Representative

801.899.7991 | sgifford@sjpiutah.com

Daniel Thomas

Regional Partner, Utah

801.899.7991 | dthomas@sjpiutah.com

Connect with us @stjohnprop    



This information contained in this publication has been obtained from sources believed to be reliable. St. John Properties makes no guarantee, warranty or representation about this information. Any projections, opinions, assumptions or estimates used here are for example only and do not represent the current or future performance of the property. Interested parties should conduct an independent investigation to determine whether the property suits their needs. REV 03/20